

mini JET

CUTTER



**MODEL
PC—1062**

INSTRUCTIONS & PARTS LIST

The **MINI JET CUTTER** provides a most powerful and amazingly fastest cutting performance, and a long trouble-free life is assured on account of specially engineered pneumatic motor.

This cutter has many distinguished features; namely, (1) Recessed shape for total visibility, (2) Powerful and duplicity noise silencer, (3) Troubleless through over-load, (4) One-touch sharpener, (5) Stationary carbide counter cutting blade, (6) Felt pad oiler and built-in lubricator, (7) Light weight only 0.9 kg (2 lbs.) (8) 6-different types of knife made from high-speed steel, (9) Grip style lever switch, and (10) Two-in-one Synchron system cutting base.

The following are the operating instructions for your Cutter (all numbers given below refers to parts list on the other side).

START TO OPERATE:

Connect **AIR INLET (M485)** to the compressor **AIR HOSE (M489)**. To operate Cutter, press **THROTTLE LEVER (M482)** and to stop operate, release Lever. The air motor uses 4.5 kg/cm² air pressure. 1.0 HP compressor required for 1 cutter (3 HP for 2 cutter). When **COILING AIR HOSE (M488)** with one touch **AIR INLET (M486, M487)** in use, change **AIR INLET (M486)** in stead of **AIR INLET (M485)** and connect with **AIR INLET SOCKET (M487)** and **COILING AIR HOSE (M488)**.

CUTTING:

Maximum cutting height is 8 mm (5/16") depending on type of materials. Lays should not be higher than its height.

To maintain perfect cutting performance, replace the **KNIFE (M700, M702 & M703)** when the knife is worn down to about 42 mm (1-5/8").

SHARPENING KNIFE:

Lightly press the sharpener **PUSH BUTTON (M528)** just enough for **SHARPENING STONE (M688Z)** to grind the rotating knife.

Don't press too hard because it will burr the knife. You should keep knife always sharp for clean and accurate cutting.

LUBRICATION:

- (a) **OIL PAD (M680)** behind knife—Requires oil only when cutting plastics or the stiff materials which is apt to adhere to knife.
- (b) **GEARS (M450 & M452-A)**—In case Cutter uses daily, grease gears each 3 days with special red **GREASE (R672)** through bushing located in back of **GEAR HOUSING (M400AZ)**.

AIR MOTOR (M490B)— When the first operation, in order to remove dust during the transportation, give a plenty of clean oil—spindle oil #60—in the **AIR INLET (M485)**. In case Cutter uses daily, drops a few oil through the oil hole before and after the operation.

SYNCHRON SYSTEM CUTTING BASE:

SYNCHRON BASE (M460) use for general cutting purpose. Unscrew the **ROUND HEAD SCREW (M548)** and remove the **BASE PLATE (M426A)**, it converts easily to a **CUTTING FOOT (M424)** with **COUNTER BLADE (M729A)** for slitting or trimming of plastics or stiff material as well as knitted fabrics.

CHANGE VANES:

When the rotation of vane lowers after several months operation, overhaul and wear checking on the **VANES (M470)** are required. In case Vanes worn remarkably at the edge it must be replaced.

Separate the **CONNECTOR (M462B-A)** from the **MOTOR CASE (M476)** by turning counter clockwise. Tap the upper part of the motor case with a wooden hammer and draw the **ROTOR (M469)** out from the top. Then, the **CYLINDER (M472)**, **COUPLING (M416)**, **NUT (M465)**, **GUIDE PLATE (M466)**, **BALL BEARING (M467 & M474)**, **BRACKET (M468 & M473)**, **ROTOR (M469)**, **VANES (M470)**, **SPRING PIN (M471)** and **END PLATE (M475)** are all drawn out at the same time. For disassembling the motor section, it is enough only to pull them lightly.

THROTTLE VALVE & LEVER:

Usually, the air inlet valve section in the motor case requires no overhaul. In case of disassembly, after removing the **VALVE SCREW (M477)** by turning counter clockwise, the **PACKING (M478)**, **SPRING (M479)**, **BALL (M480)** and **VALVE PIN (M481)** can be easily draw out. **THROTTLE LEVER (M482)** can be separated by removing the **SPRING PIN (M483)**.

CHANGE SHARPENING STONE:

Remove the knife, then loose stepped screw (**M508**) to take out sharpening mechanism. Remove sharpening stone (**M688Z**) from stepped shaft (**M602**) by unscrewing flat head screw (**M510**) and put in new sharpening stone. Remove compression spring (**M620**) by unscrewing push button (**M528**) on stepped shaft. Replace sharpening mechanism into gear housing (**M400AZ**), insert stepped screw through gear housing and into stepped shaft. Then replace compression spring and push button. To clean sharpening stone, simply use cleaning fluid and a brush to keep it clean.

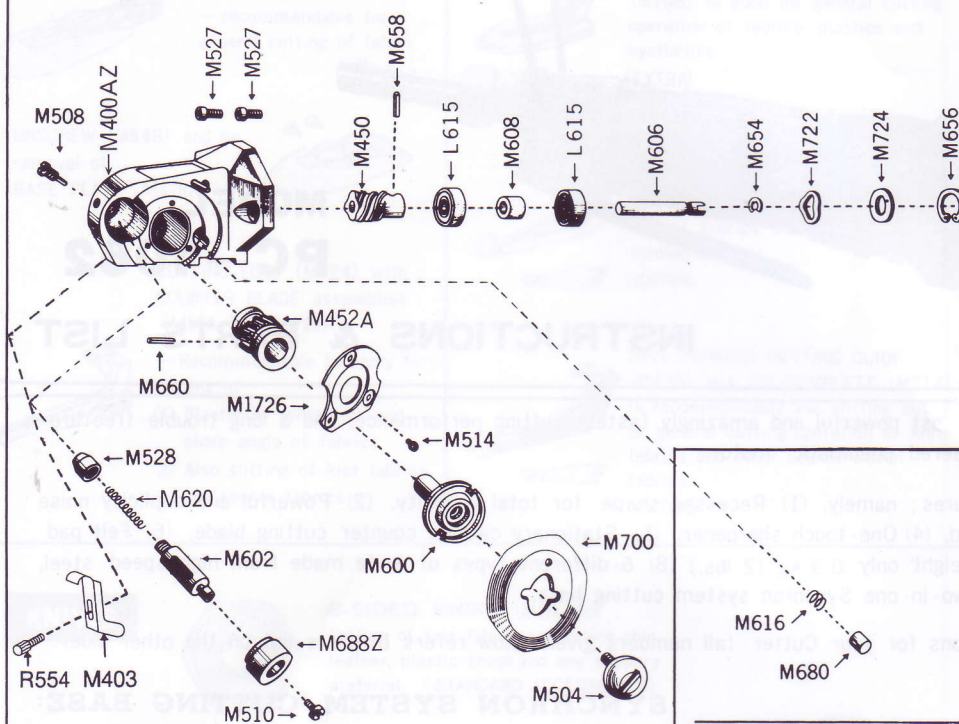
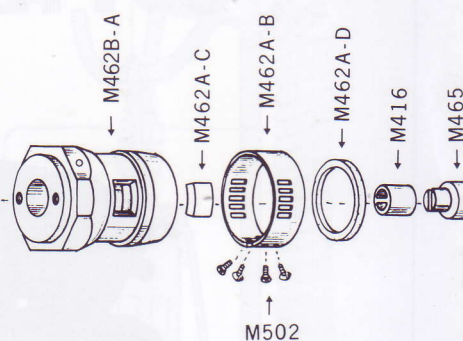
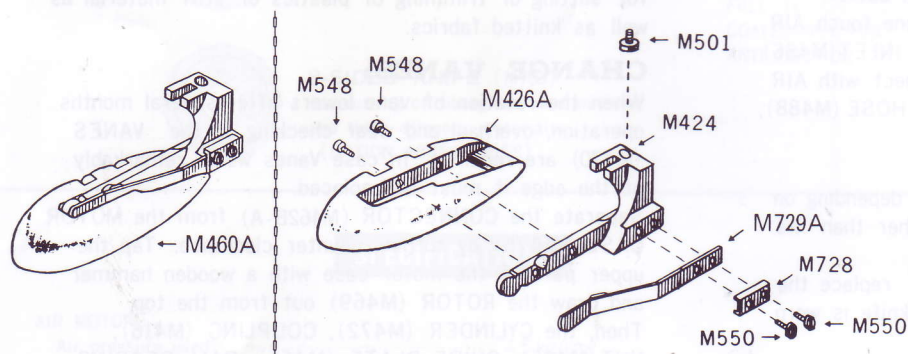
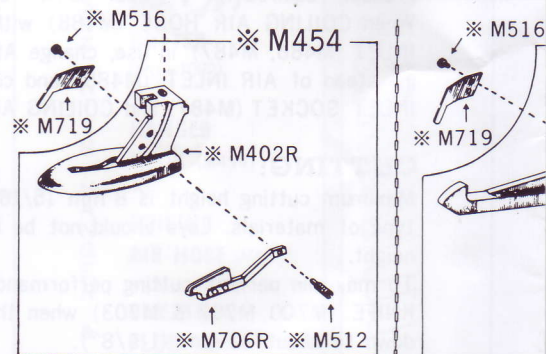
DRIVING MECHANISM**SHARPENING MECHANISM****LUBRICATING MECHANISM****AIR MOTOR ASSY. M490B****KNIVES**M700
※ M700HFM702
※ M702HF**SYNCHRON SYSTEM BASE****MICRON****DRIVING MECHANISM**

M400AZ..... Gear Housing Complete
 M450..... Worm
 M452A..... Worm Wheel
 M527..... Allen Screw
 M504..... Knife Lock Screw
 M508..... Stepped Screw
 M514..... Fillister Head Screw
 M600..... Stepped Shaft
 M606..... Shaft
 M608..... Spacer
 L 615..... Ball Bearing
 M654..... E Ring
 M656..... Snap Ring
 M658..... Spring Pin
 M660..... Spring Pin
 M700..... 6-Sided Knife

M722..... Undulated Washer
 M724..... Washer
 M1726..... Cover Plate Complete
 M440A..... Worm Wheel Assy.
 M403..... Finger Guard
 R554..... Knob Screw

SHARPENING MECHANISM

M510..... Flat Head Screw
 M528..... Push Button
 M602..... Stepped Shaft
 M620..... Spring
 M688Z..... Sharpener Stone Complete
 M444..... Sharpener Assy.

LUBRICATING MECHANISM

M616..... Spring

M680..... Oil Pad

AIR MOTOR ASSY.

M462B-A..... Connector
 M462A-B..... Silencer
 M462A-C..... Filter C
 M462A-D..... Filter D
 M416..... Coupling
 M465..... Nut
 M466..... Guide Plate
 M467..... Ball Bearing
 M468..... Front Bracket
 M469..... Rotor
 M470..... Vane
 M471..... Spring Pin
 M472..... Cylinder
 M473..... Rear Bracket
 M474..... Ball Bearing

M475.....
 M476.....
 M477.....
 M478.....
 M479.....
 M480.....
 M481.....
 M482.....
 M483.....
 M484..... Air Inl
 M485.....
 M494.....
 M490B..... AIF
 M502.....

EL PC-1062 PARTS LIST

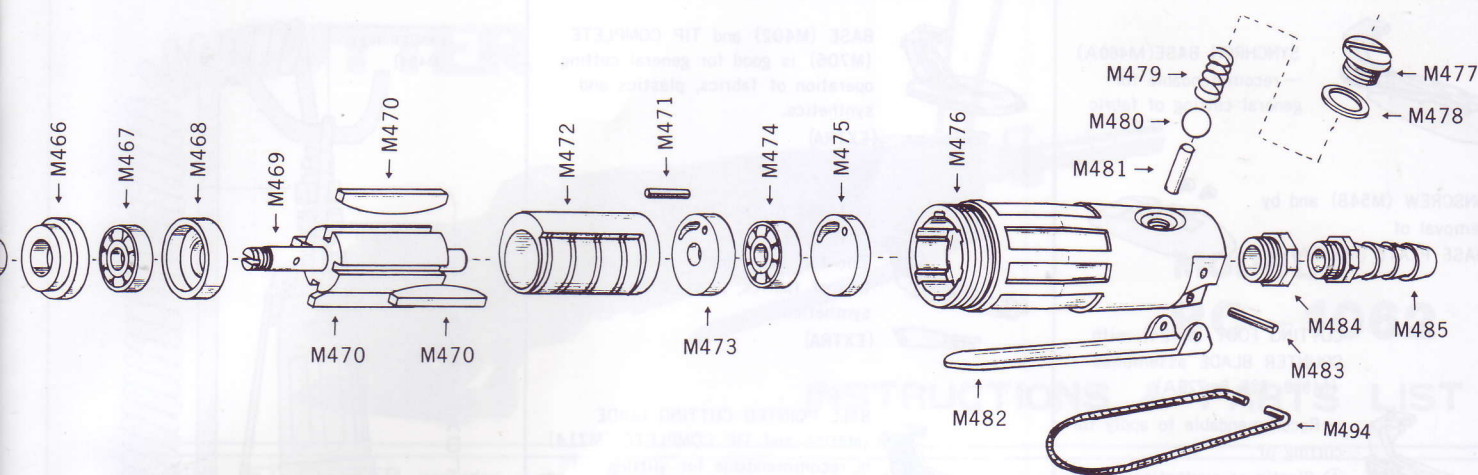

AIR HOSE

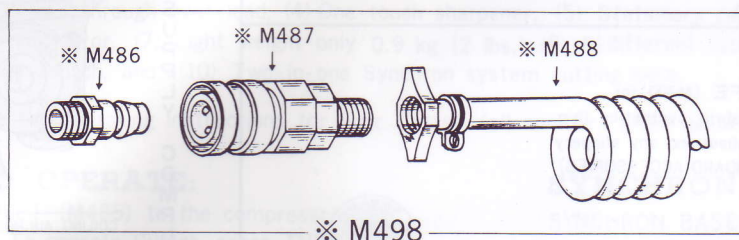

SYSTEM FEET

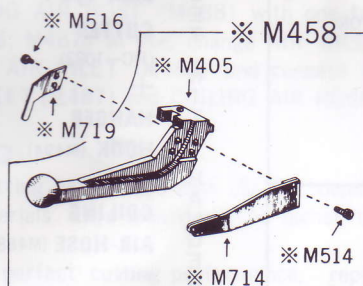

ACCESSORIES

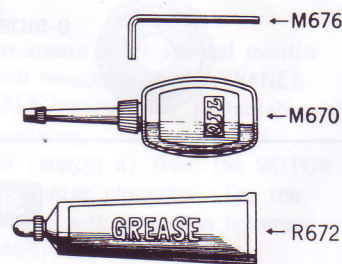
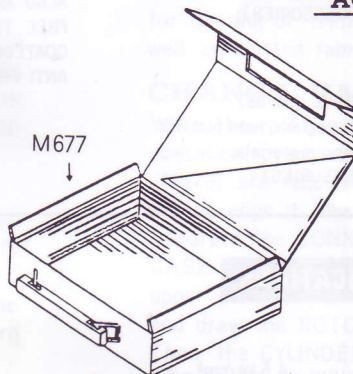

..... End Plate
..... Motor Case
..... Valve Screw
..... Packing
..... Spring
..... Ball
..... Valve Pin
..... Throttle Lever
..... Spring Pin
..... Joint (P.T.1/4)
..... Air Inlet
..... Hanger Hook
MOTOR ASSY.
..... Socket Screw

KNIVES

M700.....6-Sided Knife
※ M700HF.....Heat Free Teflon
6-Sided Knife
M702.....Round Knife
※ M702HF.....Heat Free Teflon
Round Knife
※ M703.....8-Sided Knife
※ M703HF.....Heat Free Teflon
8-Sided Knife

AIR HOSE

※ M486.....Air Inlet (for M487)
※ M487.....Air Inlet Socket
(for M488)
※ M488.....Coiling Air Hose (inside
dia. 9.5mm—3/8")
※ M489.....Polyurethane Air Hose
※ M498.....Coiling Air Hose Assy.

SYNCHRON SYSTEM BASE

M424.....Cutting Foot
M426A.....Base Plate
M501.....Flat Head Screw
M548.....Round Head Screw
M550.....Flat Head Screw
M728.....Plate
M729A.....Counter Blade Complete
M460A.....SYNCHRON BASE ASSY.

MICRON SYSTEM FEET

※ M402R.....Base
※ M404.....Cutting Guide
※ M405.....Ball Pointed Cutting Guide

※ M512.....Screw for Base
※ M514.....Fillister Head Screw
※ M516.....Truss Head Screw
※ M706R.....Cutting Tip (base)
※ M714.....Cutting Tip (Guide)
※ M719A.....Spring Plate
※ M454.....MICRON BASE ASSY.
※ M456.....CUTTING GUIDE ASSY.
※ M458.....BALL POINTED CUTTING
GUIDE ASSY.

ACCESSORIES

M670.....Oiler
R672.....Tube of Grease
M676.....Large Allen Key
M677.....Vinyle Pouch

REMARKS: PARTS (MARKED BY ※) ARE OPTIONAL PARTS
AND WILL BE SUPPLIED UPON REQUEST. WHEN
ORDERING PLEASE INDICATE IF REQUIRED.

SYNCHRON SYSTEM BASE



SYNCHRON BASE(M460A)
— recommendable for
general cutting of fabric

UNSCREW (M548) and by
removal of
BASE PLATE (M426A)



CUTTING FOOT (M424) with
COUNTER BLADE assemblies
(M550, 728 & 729A)



— Recommendable to apply for
cutting of

- ① Plastic or synthetics and
sharp angle of fabrics
- ② Also slitting of knit fabrics
and coarse fabrics

MICRON SYSTEM FEET

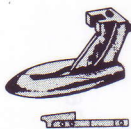

BASE (M402) and TIP COMPLETE
(M706) is good for general cutting
operation of fabrics, plastics and
synthetics.
(EXTRA)



CUTTING GUIDE (M404) and TIP
COMPLETE (M714) is recommend-
able for sharp angle cutting opera-
tion of fabrics, plastics and
synthetics.
(EXTRA)

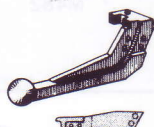

BALL POINTED CUTTING GUIDE
(M405) and TIP COMPLETE (M714)
is recommendable for slitting cut
or general cutting operation of knit
fabrics and other coarse woven
fabrics.
(EXTRA)

KNIVES

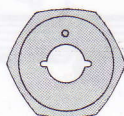

6-SIDED KNIFE (M700) for
cutting of knit fabric, synthetics thin
leather, plastic sheet and any slippery
material. (STANDARD ACCESSORIES)

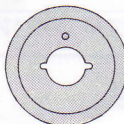

ROUND KNIFE (M702)
for cutting of light to medium heavy
weight of all type of fabrics and papers.
(STANDARD ACCESSORIES)

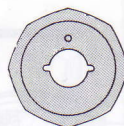

8-SIDED KNIFE (M703)
for cutting of fibreglass, hard plastics
and thick, slippery materials.
(OPTION ACCESSORIES)



ALSO AVAILABLE HEAT
FREE TEFLON
COATED KNIFE FOR
ANTI FRICTION

SPECIFICATIONS

AIR MOTOR:

Air pressure used.....	: 4.5 kg/cm ²
Max. horse power.....	: 0.4 HP (300 W)
Max. Torque.....	: 0.032 kg-m
Max. Speed with load.....	: 9,000 r.p.m. (without load 20,000 r.p.m.)
Max. Air consumption with load.....	: 3.8 m ³ /min. (without load 0.45 m ³ /min.)

AIR INLET:

Outside Diameter.....	: 9.5 mm (3/8")
Inlet screw threading.....	: 1/4 PT
Compressor (recommendable).....	: 1.0 HP compressor for 1 cutter

CUTTER:

Cutter.....	: 3.0 HP compressor for 2 cutter
Diameter of knife.....	: 50 mm (2")
Dimension.....	: (H) 80 mm × (W) 50 mm × (L) 235 mm
Standard accessories.....	: 2-knife(round and 6-sided), 1-allen screw wrench, 1-grease, and 1-oil.

WEIGHT :..... : (NW) 0.9 kg (GW) 1.3 kg

HANGING STAND

HANGER HOOK
(M494)

ONE TOUCH
PLUG
(M486 +
487)

AVAILABLE TO SUPPLY COMPLETE SET WITH HANGER & STAND

COILING AIR-HOSE
(M488)

**Mini-JET
CUTTER**

(PC-1062)
+
**HANGER
HOOK (M494)**
+
**COILING
AIR-HOSE (M488)**
with
**ONE TOUCH
PLUG (M486 + 487)**
+
**HANGING
STAND (M499)**

HANGING STAND
(M499)

AGENT:

Catalog #08.03. 1000MDOC