

WAYKEN®

CLOTH CUTTING MACHINE

Instruction Manual and Parts List

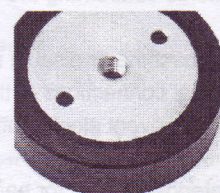
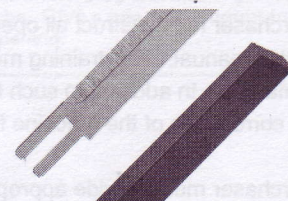
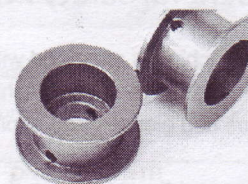

ORIGINAL INSTRUCTIONS

WARNING

This machine is equipped with a very sharp knife. Keep hands, arms, and hair away from the knife area at all times.

Misuse of this machine or failure to follow all safety instructions on this machine and in the instruction manual may result in serious personal injuries.

MADE in TAIWAN

■ Safety Information

Throughout this manual, safety information is presented by use of the terms *Warning*, *Caution*, and *These* terms have the following meanings:

■ Safety and Indemnification

During the life of the machine, the purchaser agrees to provide to all machine users (including its own employees and independent contractors) all relevant safety information, including warning labels and instruction manuals.

The purchaser also agrees to maintain the safety features and working condition of the machine, and to adequately train all users in the safe use and maintenance of the machine.

The purchaser agrees to defend, protect, indemnify, and hold machine supplier harmless from and against all claims, losses, expenses, damages, and liabilities to the extent that they have been caused by the purchaser's failure to comply with the terms and instructions of this manual.



CAUTION

A caution contains instructions for the use or maintenance of the machine. Failure to follow these procedures may result in damage to the machine.



WARNING

A warning contains critical information regarding potential safety hazards that can occur during proper use or misuse of the machine. Failure to follow these procedures may result in serious personal injury to the user.

■ General Safety Precautions

This machine is equipped with a very sharp and dangerous knife. Keep hands, arms, and hair away from the knife area at all times. When the machine is not in use, keep the pressure foot knife guard lowered and locked at all times. Safety gloves and glasses and appropriate clothing may prevent serious personal injuries.

Disconnect the power supply from the machine when it is not in use or during routine maintenance, including lubrication.

The purchaser must instruct all operators in the proper use of the machine according to the instructions on the machine and in this manual. This training must include instruction on the potential safety hazards arising from the use or misuse of the machine. In addition to such training, the purchaser should provide written work instructions as necessary to ensure correct use of the machine for specific cutting applications.

The purchaser must provide appropriate safety measures and equipment as recommended in this manual. Observe all statutory requirements concerning the use of hazardous machinery that apply to your location.

Do not modify this machine or disable safety features. Unauthorized modification may result in serious personal injuries to the user. Electrical connections to this machine must be made by a qualified electrician familiar with applicable codes and regulations. To prevent electrocution, a ground lead must be connected to terminal "E" on the attachment plug.

This machine is intended ONLY for hand-held operation. Misuse of this machine or use of this machine as part of another machine may result in serious personal injuries to the user.

Safety labels must be kept clean and legible at all times. Call the machine supplier to order replacement labels.

■ Instructions

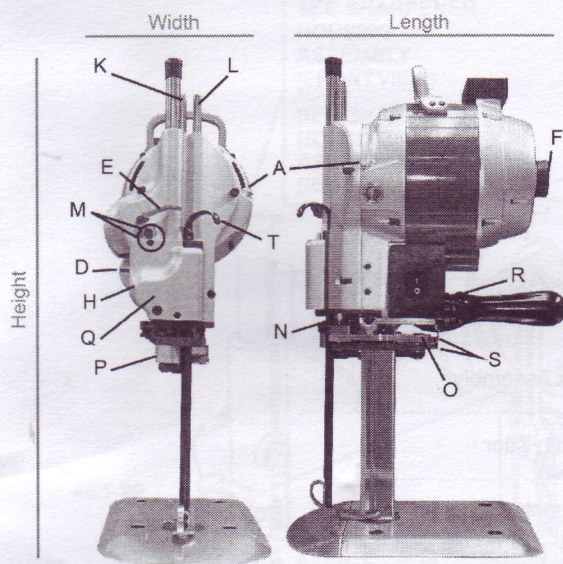

- | | | | |
|---|--------------------------|---|--|
| A | oil reservoir | N | pulley shaft |
| D | release lever | O | belt pulley |
| E | sharpener lever | P | plug |
| F | turning knob | Q | cover |
| H | bell crank release lever | R | pressure foot lever |
| K | tube | S | sharpener bracket |
| L | tube | T | knife guard/pressure foot lifting handle |
| M | oil | | |

Controls and Adjustments

	Height	Width	Length
8"	51.3CM	26.5CM	30CM
10"	61.5CM	26.5CM	30CM

START ON

1. Fill oil cup A, be sure oil goes into smooth, if not, remove obstruction.
2. Push in F and turn the machine by hand for a few revolutions to make sure the oil is spread over contact surfaces.
3. The sharpener must be always up in locked position when starting.

BE CAREFUL

- a. Keep the machine in warm place in cold weather.
- b. Repeat short on & off before permitting the machine to run continuously for preventing excessive friction between contact surfaces.
- c. Do not use too much oil. Do not use sewing machine oil. Use a least good grade of No. 100 motor oil.

LUBRICATION

EVERY 2 HOURS DAILY	ONCE A WEEK	ONCE A MONTH
1. Fill oil tank A (no need to oil at connecting rod bearing)	One drop oil to: 1. Tubes-K&L 2. Turn Knob-F 3. Pulley Shaft-N 4. Belt Pulleys-R	Remove P plug and insert grease tube. Give a pea-size amount to the opening.

SHAPENER OPERATION

1. Put the machine away from piles of material.
2. Turn the power on. Drop pressure foot by lever located next to operating handle
3. Press lever E downward firm but not too quick.

BE CAREFUL

- a. Do not operate sharpener without knife in machine.
- b. Do not operate sharpener with cutting material laid in machine.
- c. Do not shut off motor while sharpener is in motion.
- d. If lever E is locked in halfway by too quick operation, lift lever H to unlock and start again.

CARE

1. Blow lint out of motor and sharpener by blower or something alike twice a week.
2. Lint around screw mechanism of sharpener inside cover H must be cleaned once a week.
3. Clean the knife slide once a day.
4. Remove lint from rollers in base plate. To prevent undue accumulation of lint, do not oil plate rollers. If rollers stick, remove from plate and wash in cleaning solvent.

■ Index List

Exploded View	1
Single-Phase Motor Assembly (Assembled View)	2
Single/Dual-Phase Motor Assembly (Exploded View)	3
Front Bearing Housing with Oiler Assembly (Exploded View)	4
Sharpener Housing Assembly (Assembled, Front View)	5
Sharpener Housing Assembly (Exploded, Front View)	7
Sharpener Housing Assembly (Assembled, Rear View)	8
Sharpener Housing Assembly (Exploded, Rear View)	9
Lower Gear Bracket Assembly (Assembled View)	10
Lower Gear Bracket Assembly (Exploded View)	11
Standard and Baseplate Assembly (Assembled View)	12
Standard and Baseplate Assembly (Exploded View)	13
Removing a Worn Plate Roller Shell	14

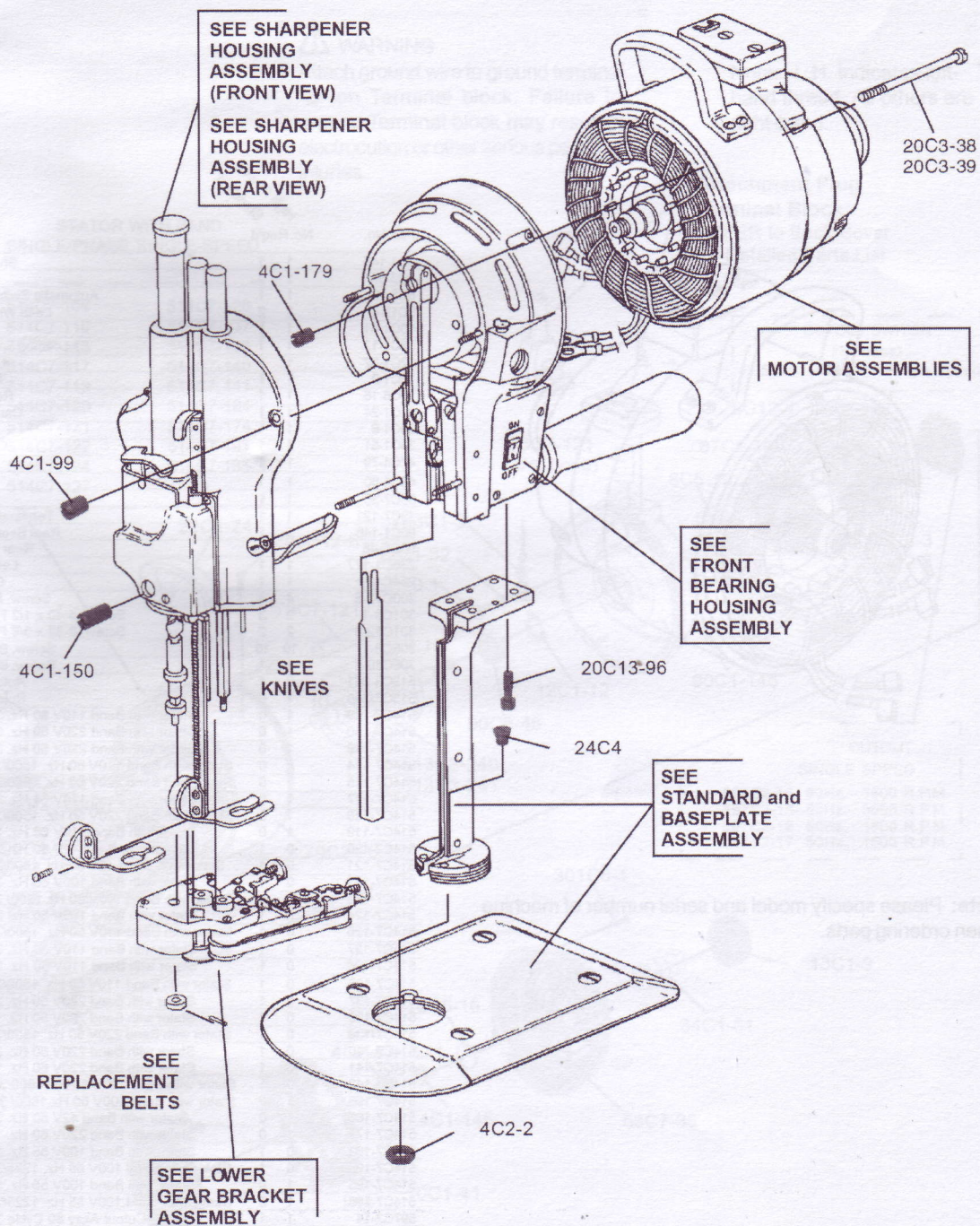

■ Single-Phase Motor Assemblies

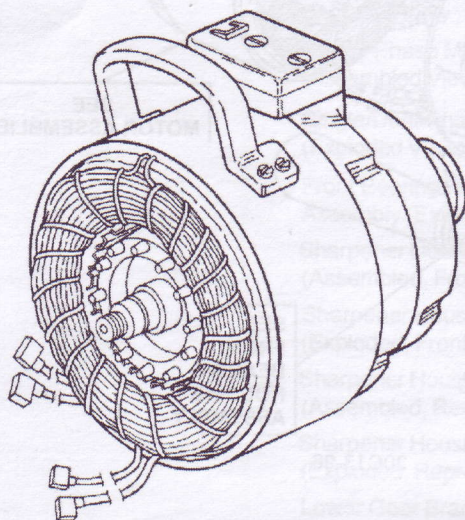

Note: Please specify model and serial number of machine when ordering parts.

Part No.	No. Req'd		Description
	High Power	Standard	
4C1-145	1	1	Shaft Lock Nut
4C2-87	1	1	Nut, Clutch
8C5-10	1	1	Automatic Switch Insulation
8C12-4	2	2	Lead Wire Insulation
10C1-41	1	1	Rotor Fan
12C1-12	1	1	Loading Spring Washer
12C1-32	1	1	Lock Washer
13C1-9	1	1	Turning Knob
18C6-16	1	1	Retaining Ring
22C1-24	1	1	Carrying Handle
30C1-8	1	1	Dust Cap
34C1-51	1	1	Clutch Spring
47C4-79	1	1	Terminal
47C4-80	1	1	Terminal
53C7-35	1	1	Fan Cover
73C7-121	1	1	Terminal Wire Tubing
90C1-146	1	1	Rear Bearing Housing
90C6-46	1	1	Rear Ball Bearing
236C1-177	1	1	Label, Warning
254C1	1	1	Cable Tie, 4"
300C12-6	4	4	Screw, Round Head
301C8-1	3	3	Screw, 4-40 x 1/2 Fillister Head
301C12-3	2	2	Screw, 8-32 x 3/8 Fillister Head
305C8-1	10	10	Screw, Binding Head
305C10-1	1	1	Screw, Binding Head
513C3-241	0	1	Rotor and Shaft
513C3-240	1	0	Rotor and Shaft
514C7-109	1	0	Stator with Band 110V 60 Hz. 3600 R.P.M.
514C7-110	1	0	Stator with Band 220V 60 Hz. 3600 R.P.M.
514C7-113	1	0	Stator with Band 220V 50 Hz. 3000 R.P.M.
514C7-114	1	0	Stator with Band 110V 60 Hz. 1800/3600 R.P.M.
514C7-115	1	0	Stator with Band 220V 60 Hz. 1800/3000 R.P.M.
514C7-117	1	0	Stator with Band 110V 50 Hz. 3000 R.P.M.
514C7-118	1	0	Stator with Band 220V 50 Hz. 1500/3000 R.P.M.
514C7-119	1	0	Stator with Band 110V 50 Hz. 1500 R.P.M.
514C7-120	0	1	Stator with Band 42V 50 Hz. 3000 R.P.M.
514C7-121	0	1	Stator with Band 42V 50 Hz. 1500/3000 R.P.M.
514C7-122	0	1	Stator with Band 100V 60 Hz. 3600 R.P.M.
514C7-123	0	1	Stator with Band 100V 60 Hz. 1800/ 3600 R.P.M.
514C7-124	0	1	Stator with Band 180V 50 Hz. 3000 R.P.M.
514C7-126	0	1	Stator with Band 110V 50 Hz. 1500/3000 R.P.M.
514C7-127	0	1	Stator with Band 110V 60 Hz. 3600 R.P.M.
514C7-128	0	1	Stator with Band 110V 60 Hz. 1800 R.P.M.
514C7-129	0	1	Stator with Band 110V 60 Hz. 1500/3000 R.P.M.
514C7-137	0	1	Stator with Band 220V 50 Hz. 3000 R.P.M.
514C7-138	0	1	Stator with Band 220V 50 Hz. 1500 R.P.M.
514C7-139	0	1	Stator with Band 220V 50 Hz. 1500/3000 R.P.M.
514C7-140	0	1	Stator with Band 220V 60 Hz. 3600 R.P.M.
514C7-141	0	1	Stator with Band 220V 60 Hz. 1800 R.P.M.
514C7-142	0	1	Stator with Band 220V 60 Hz. 1800/3600 R.P.M.
514C7-156	1	0	Stator with Band 100V 60 Hz. 1800/ 3600 R.P.M.
514C7-165	1	0	Stator with Band 42V 50 Hz. 3000 R.P.M.
514C7-174	1	0	Stator with Band 220V 60 Hz. 1800 R.P.M.
514C7-193	0	1	Stator with Band 100V 55 Hz. 3300 R.P.M.
514C7-194	0	1	Stator with Band 100V 55 Hz. 1725/3300 R.P.M.
514C7-195	1	0	Stator with Band 100V 55 Hz. 3300 R.P.M.
514C7-196	1	0	Stator with Band 100V 55 Hz. 1725/3300 R.P.M.
597C2-14	1	1	Cutout Assy 60 Cycle 3600 R.P.M.
597C2-15	1	1	Cutout Assy 50 Cycle 3000 R.P.M.
597C2-16	1	1	Cutout Assy 60 Cycle 1800 R.P.M.
597C2-17	1	1	Cutout Assy 50 Cycle 1500 R.P.M.
597C2-18	1	1	Cutout Assy 50 Cycle 1500/3000 R.P.M.
597C2-25	1	1	Cutout Assy 60 Cycle 1800/3600 R.P.M.
783C1-3	1	1	Grounding Wire Assy.

⚠ WARNING

Attach ground wire to ground terminal "E" on Terminal block. Failure to ground Terminal block may result in electrocution or other serious personal injuries.

Note: L.H. indicates left-hand thread. All others are right-hand.

Attachment Plug

Terminal Block

REFER to Back Cover for Detailed Parts List

STATOR WITH BAND SINGLE-PHASE SINGLE-SPEED

514C7-109	514C7-128
514C7-110	514C7-137
514C7-113	514C7-138
514C7-117	514C7-140
514C7-119	514C7-141
514C7-120	514C7-164
514C7-121	514C7-174
514C7-122	514C7-193
514C7-124	514C7-195
514C7-127	

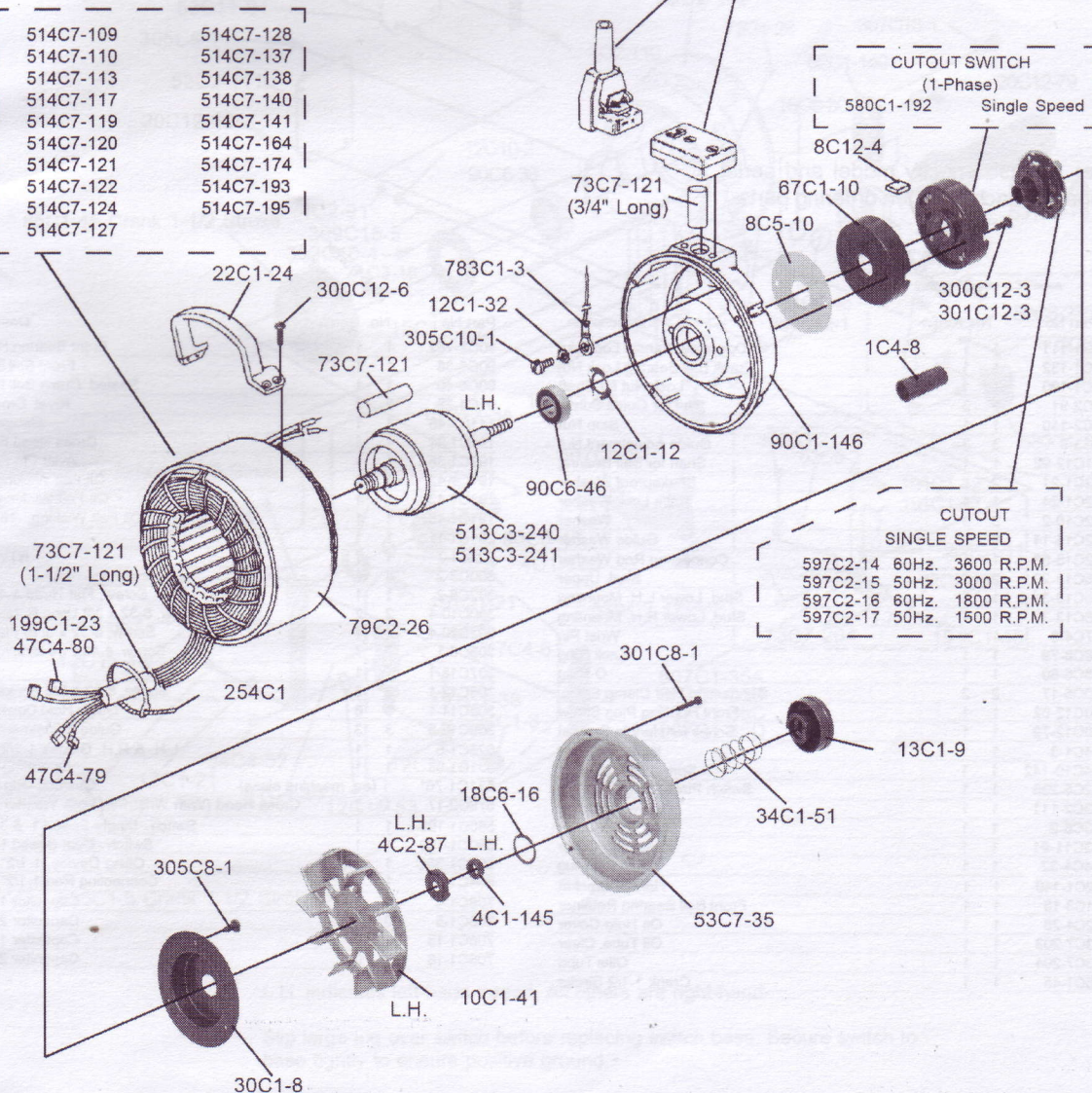

■ Front Bearing Housing with Oiler Assembly

Note: Please specify model and serial number of machine when ordering parts.

Part No.	No. Req'd	Description
4C1-111	1 1	Operating Handle Lock Nut
4C1-132	1 1	Crank Ball Bearing Lock Nut
4C1-190	1 1	Lock Nut for Shaft
4C2-91	3 3	Nut for Guide Screw
4C2-110	1 1	Stop Nut
4C3-8	3 3	Guide Adjustment Nut
11C12-92	1 1	Shaft for Ball Bearing
12C1-21	2 2	Shakeproof Washer
12C1-24	1 1	Knife Lock Washer
12C10-2	3 3	Washer
12C15-14	6 6	Guide Washer
12C15-53	1 1	Connecting Rod Washer
15C13-23	2 2	Stud, Upper
15C13-34	1 1	Stud, Lower L.H. Mounting
15C13-39	1 1	Stud, Lower R.H. Mounting
17C4-6	1 1	Wrist Pin
18C6-79	1 1	Lock Ring
18C6-80	1 1	O-Ring
20C5-17	2 2	Connecting Rod Clamp Screw
20C12-62	1 1	Front Housing Plug Screw
20C12-79	1 1	Screw for Handle Bracket
24C1-3	1 1	Knife Lock Bolt
34C10-142	1 1	Spring for Capacitor
52C5-235	1 1	Switch Plate (Single-Speed)
53C2-111	1 1	Switch Cover
53C6-2	1 1	Oiler Tube Cover
53C11-91	1 1	Capacitor Cover
54C4-32	1 1	Wrist Pin Plug
62C1-140	1 1	Handle Bracket
71C3-18	1 1	Front Ball Bearing Retainer
72C4-28	1 1	Oil Hole Cover
73C7-203	1 1	Oil Tube, Clear
73C7-204	1 1	Oil Tube
85C1-45	1 1	Crank 1-1/2 Stroke

Part No.	No. Req'd	Description
90C2-162	1 1	Front Bearing Housing
90C6-38	1 1	Front Ball Bearing
90C6-46	1 1	Seated Crank Ball Bearing
91C4-25	2 2	Rivet Crosshead
141C1-46	1 1	Gauge, Clear
191C1-21	1 1	Cross Head Felt pad
191C1-38	1 1	Wrist Pin Felt Pad
191C1-42	1 1	Oil Felt Wicking, Long
191C1-43	1 1	Oil Felt Wicking, Short
191C1-45	1 1	Oil Felt Wicking, .187 x .44
201C1-11	1 1	Eyelet
222C1-7	1 1	RTV Sealer
300C3-2	4 4	Screw
302C8-2	1 1	Screw, Flat Head 4-40 x 3/4
300C10-4	2 2	Screw, 6-32 x 3/8 Long Round Head
302C10-4	4 4	Screw, 6-32 x 5/16 Flat Head
305C8-1	7 7	Screw, 4-40x 1/4 Binding Head
307C18-1	1 1	Screw
308C12-1	3 3	Screw, 8-32 x 3/8 Socket Head
308C14-1	6 6	Guide Hold Down Screw
309C15-5	3 3	Guide Adjustment Screw
525C1-5	1 1	L.H. & R.H. Guides 1-1/2 Stroke
531C1-53	1 1	Operating Handle
531C1-76*	1 (ea. machine class)	Cushion Grip Handle
579C2-17	1 1	Cross Head (With Wrist Pin, Lock Washer & Bolt)
580C1-198	1 1	Switch - Single-Speed 1- & 3-Phase
580C1-199	1 1	Switch - Dual-Speed 1-Phase
607C1-35C	1 1	Oiling Device, 1-1/2" Stroke
664C1-4	1 1	Connecting Rod 1-1/2" Stroke
706C1-4	0 1	Capacitor 110 Volt
706C1-5	0 1	Capacitor 220 Volt
706C1-13	1 0	Capacitor 110 Volt
706C1-18	1 0	Capacitor 220 Volt

Note: Certain 220 volt machines will use these capacitors. Please check the capacitor number on label of your machine to order.

706C1-4	110 Volt
706C1-5	220 Volt
706C1-13	110 Volt
706C1-18	220 Volt

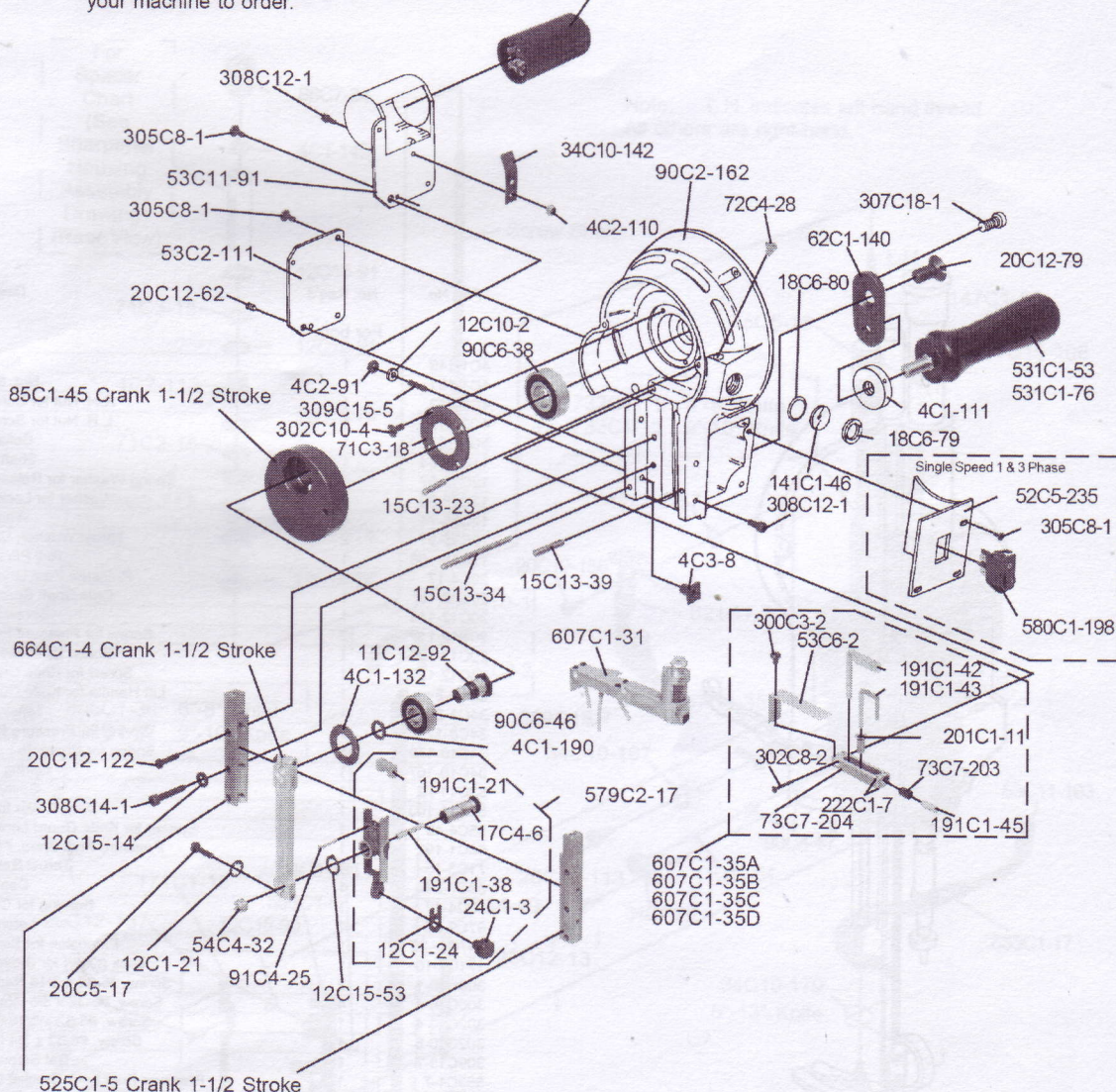

Notes: L.H. indicates left-hand thread. All others are right-hand.

Slip large lug over switch before replacing switch base. Secure switch to base tightly to ensure positive ground.

■ Sharpener Housing Assembly

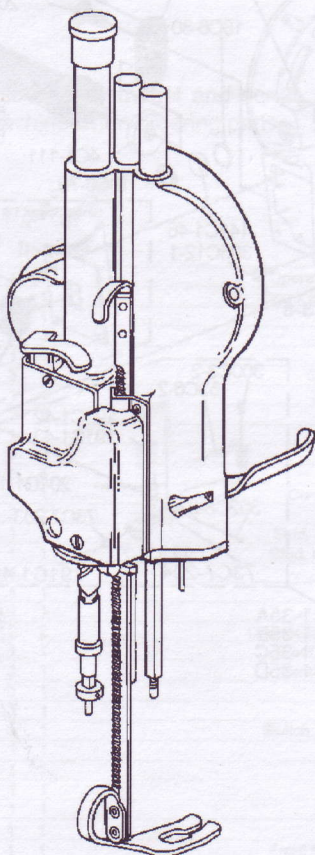

(Assembled, Front View)

Note: Please specify model and serial number of machine when ordering parts.

Part No.	No. Req'd	Description
For both		
4C1-149	1	Nut, Elastic
4C1-161	1	Nut, Self Lock
4C2-112	1	R.H. Nut for Screw Shaft
4C2-113	1	L.H. Nut for Screw Shaft
5C5-16	1	Collar, Lower
11C12-54	1	Shaft for Cam
12C15-57	1	Spring Washer for Release Lever
12C15-69	1	Washer for Lock Bracket
12C15-74	4	Washer, Flat
12C15-91	2	Thrust Washer, Upper Nut
17C15-106	1	Roll Pin for Collar
20C4-17	1	Pressure Foot Lever Screw
20C12-13	1	Cam Shaft Spring Screw
20C12-113	1	Screw for Latch
20C12-117	2	Screw for Pressure Foot Shoe
20C12-156	1	Screw for Release Lever
20C12-137	1	Screw for Knife Guard Lock
22C3-2	1	Lift Handle for Knife Guard Lock
34C1-20	1	Tension Spring
34C8-12	1	Spring for Pressure Foot Lock
34C10-179	1	Spring for Pressure Foot Lever
34C10-107	1	Spring for Latch
53C11-72	1	Cover for Cam
53C11-103	1	Vinyl Cover for Handle
55C4-49	1	Spacer for Knife Guard Lock Bracket
68C1-192	1	Pressure Foot Shoe, All Strokes
71C3-15	3	Thrust Ball Bearing
86C7-34	1	Cap for Tube
90C4-47	1	Bearing for Cam Shaft
97C3-35	1	Latch for Cam
147C1-26	1	Extension for Screw Shaft
171C1-16	1	Lock (Only) for Pressure Foot
300C10-1	2	Screw, #6-32 x 3/16 Round Head
300C10-4	4	Screw, #6-32 x 3/8 Round Head
302C10-4	1	Screw, #6-32 x 5/16 Flat Head
302C10-8	1	Screw, #6-32 x 3/4 Flat Head
309C15-7	1	Set Screw for Cam
553C1-7	1	Pressure Foot Lock Bracket Complete
553C1-8	1	Pressure Foot Lock Bracket Only
605C1-36	1	Pressure Foot Rod 7"-8" Knife
605C1-37	1	Pressure Foot Rod 9"-10" Knife
621C1-7	1	Release Lever With Cam
683C1-17	1	Pressure Foot Lever
713C4-4	1	Screw Shaft With Extension, R. & L. Hand Nuts 5"-8"
713C4-5	1	Screw Shaft With Extension, R. & L. Hand Nuts 9"-10"
732C1-11	1	Sharpener Housing (With Bushings and Tubes) Only 5"-8" Knife
732C1-12	1	Sharpener Housing (With Bushings and Tubes) Only 9"-10" Knife

* THESE PARTS SOLD ONLY IN
ASSEMBLIES AS FOLLOWS

713C4-4 Screw Shaft with Extension, R. & L. Hand Nuts 5"-8"
713C4-5 Screw Shaft with Extension, R. & L. Hand Nuts 9"-10"

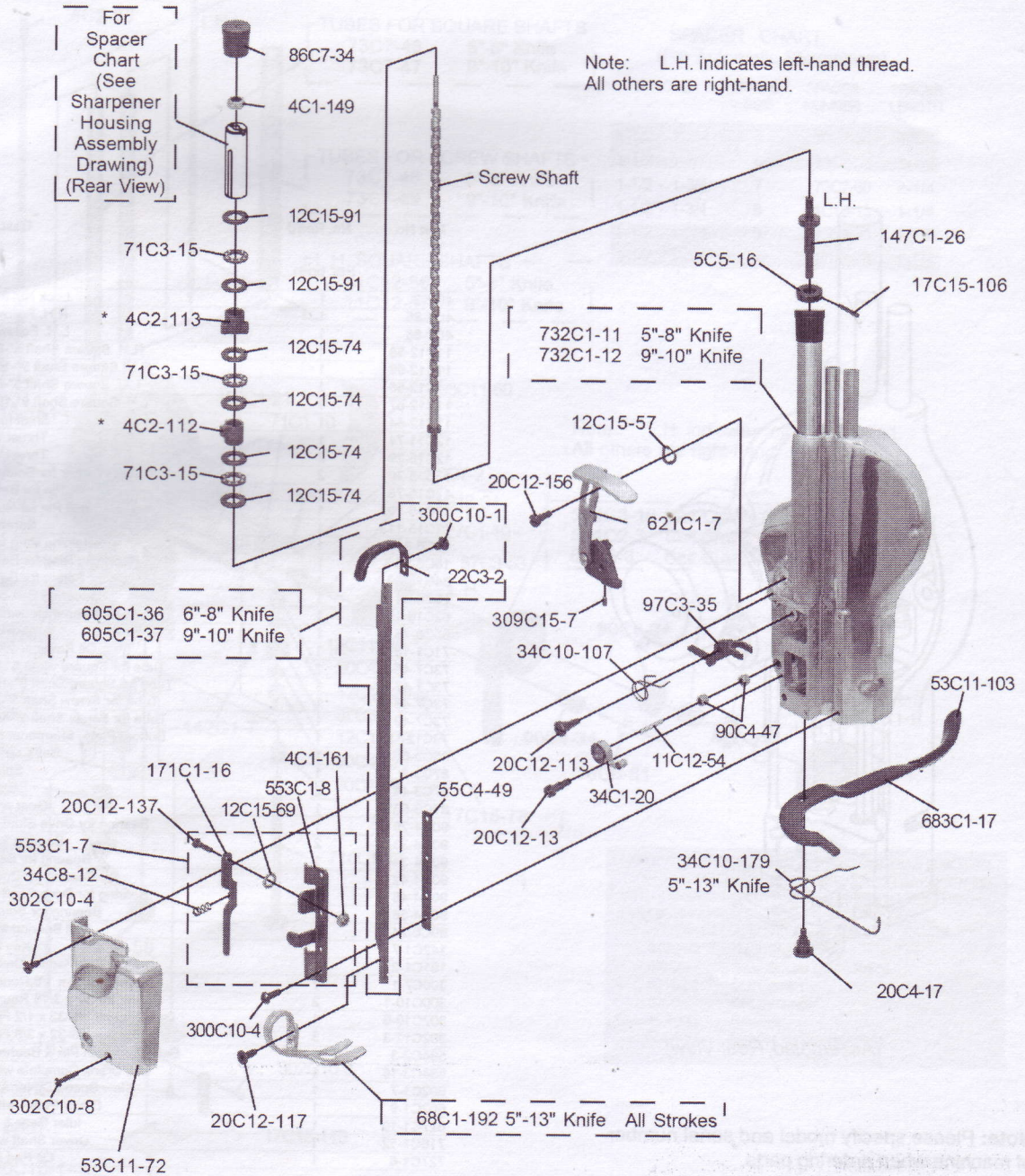

■ Sharpener Housing Assembly

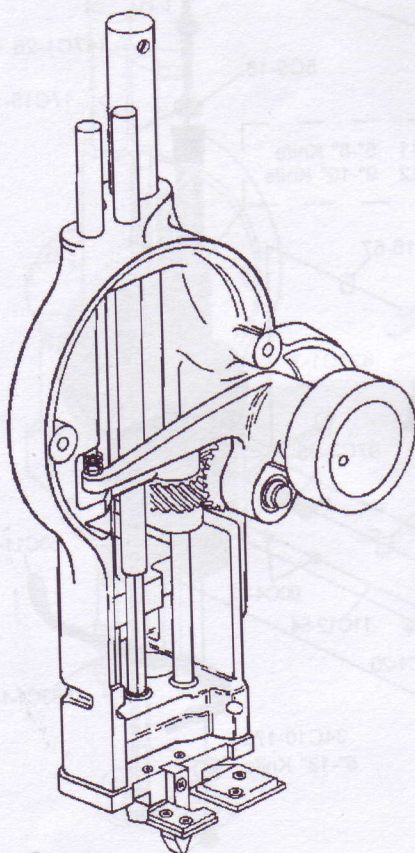

(Assembled, Rear View)

Note: Please specify model and serial number of machine when ordering parts.

Part No.	No. Req'd	Description
For both		
4C2-2	1	Lock Nut for Shaft
4C2-85	1	R.H. Follower Nut
4C2-86	1	L.H. Follower Nut
11C12-58	1	R.H. Square Shaft 5"-8" Knife
11C12-59	1	R.H. Square Shaft 9"-10" Knife
11C12-56	1	L.H. Square Shaft 5"-8" Knife
11C12-57	1	L.H. Square Shaft 9"-10" Knife
11C12-64	1	Shaft for Crank
12C11-74	1	Thrust Washer
12C15-29	2	Thrust Washer
12C15-30	2	Thrust Washer for Bottom Plate
17C15-78	1	Pin for Bell Crank
17C15-103	1	Roll Pin for Push Rod
17C15-113	1	Spreader Pin
18C6-81	1	Retaining Ring for Shaft
18C6-26	1	Retaining Ring for Bell Crank
34C10-89	1	Spring for Bell Crank
55C4-41	1	Spacer for Ball Bearings
62C16-151	1	Sharpener Housing (Only)
65C6-75	1	Push Rod
71C1-10	1	Oil Retainer-Idler Gear
73C7-46	1	Tube for Square Shaft 5"-8" Knife
73C7-47	1	Tube for Square Shaft 9"-10" Knife
73C7-48	1	Tube for Screw Shaft 5"-8" Knife
73C7-49	1	Tube for Screw Shaft 9"-10" Knife
79C12-163	1	Bottom Plate, Sharpener Housing
85C3-6E	1	Bell Crank (Only)
87C3-8	1	Spiral Gear
87C3-44	2	Spur Gear
87C3-53	1	Gear and Shaft
90C4-29	1	Bearing for Drive Shaft (Lower)
90C4-33	2	Bearing for Gears
90C4-34	1	Bearing for Bell Crank
90C4-42	1	Bearing for Drive Shaft
90C4-48	1	Bearing for Drive Shaft (Upper)
90C4-58	1	Bearing for Screw Shaft
90C6-24	2	Ball Bearing for Crank
142C1-7	1	Key for Gear
191C1-21	1	Felt Pad for Cross Head
300C7-1	1	Screw, #4-36 x 1/8 Round Head
300C10-1	2	Screw, #6-32 x 3/16 Round Head
302C10-6	1	Screw, #6-32 x 1/2 Flat Head
302C12-3	3	Screw, #8-32 x 3/8 Flat Head
584C2-3	1	Bell Crank with Pin & Bearing (Only)
584C3-16	1	Bell Crank Complete with Lever
602C1-7	1	Slow Speed Driver Assembly
602C1-9	1	Driver Pulley with Driver
627C1-10	1	Idler Gear & Bushing
716C1-12	1	Driver Shaft with Gear
727C1-6	1	Oil Pad & Holder

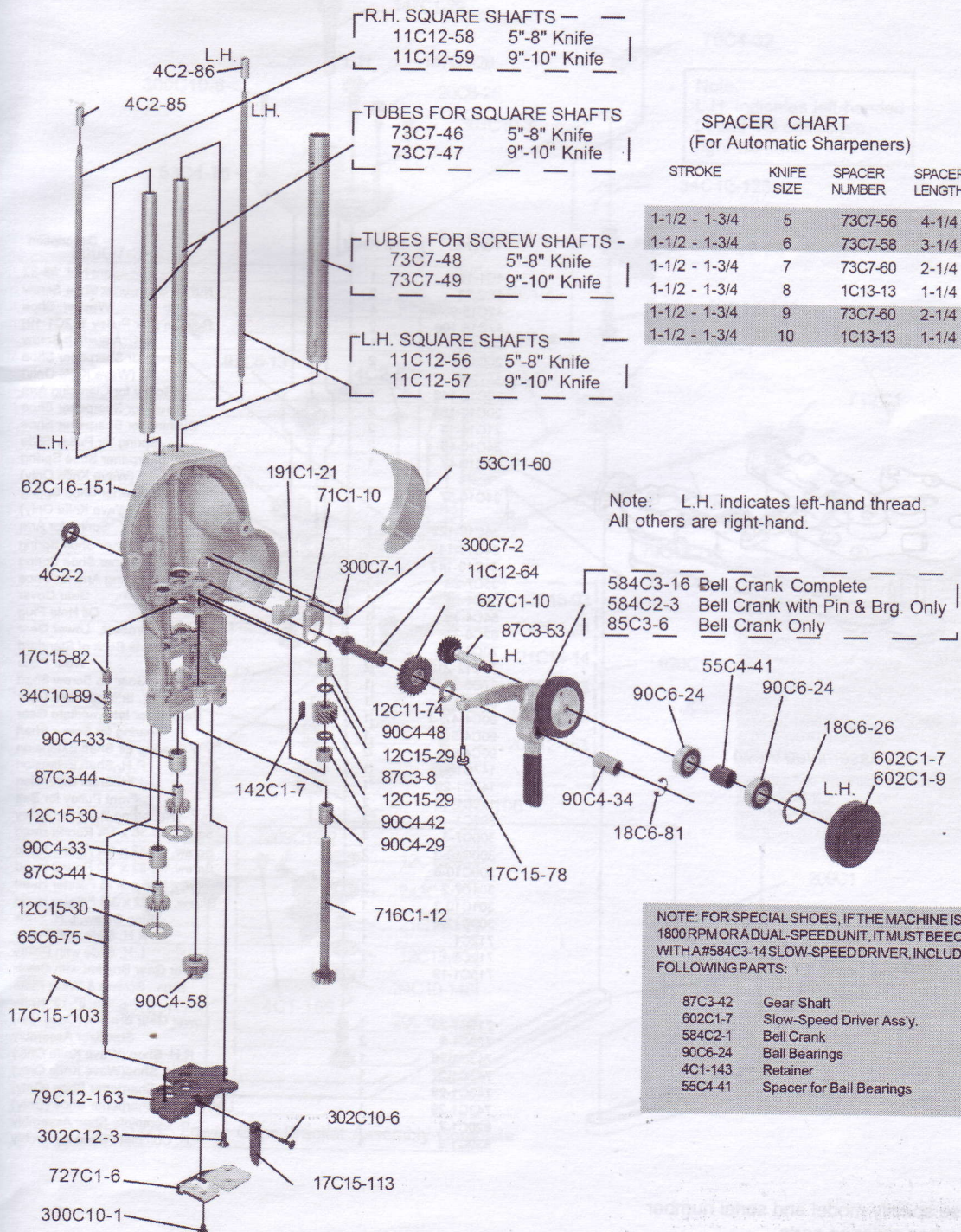

■ Lower Gear Bracket Assembly

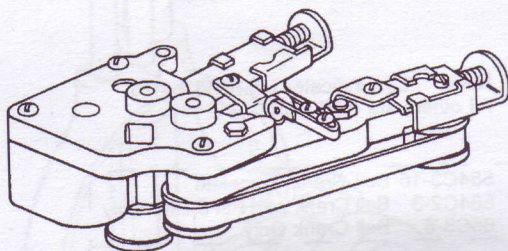

(Assembled View)

Part No.	No. Req'd	Description
4C1-189	1	Jam Nut, #8-32
4C2-63	2	Nut for Sharpener Shoe Screw
12C15-93	4	Washer, Shoe
17C15-106	2	Roll Pin (For Pulley 152C1-19)
20C6-25	1	Adjusting Screw
20C12-57	2	Screw for Sharpener Shoe (Wave Knife Only)
20C12-143	1	Screw for Clamping Arm
20C12-153	2	Screw for Sharpener Shoe
21C14-14	2	Bushing for Sharpener Shoe
34C10-45	2	Spring for Pulley Slide
34C10-47	1	L.H. Sharpener Shoe Spring (Wave Knife Only)
34C10-57	1	R.H. Sharpener Shoe Spring (Wave Knife Only)
34C10-123	1	Spring for Arm
34C10-148	1	L.H. Sharpener Shoe Spring
34C10-149	1	R.H. Sharpener Shoe Spring
35C7-28	1	Clamping Arm for Shoe
53C4-78	1	Gear Cover
54C4-35	1	Oil Hole Plug
62C6-31	1	Bracket, Lower Gear
70C4-32	1	Guide Back of Standard
79C12-219	2	Wear Plate
87C3-50	1	Gear on Screw Shaft
87C5-13	1	Intermediate Gear
90C4-47	1	Bearing for Intermediate Gear
90C4-51	1	Bearing for Screw Shaft
90C4-59	2	Bearing for Shaft Extension
147C1-28	1	R.H. Shaft Extension
147C1-29	1	L.H. Shaft Extension
152C1-19	2	Front Pulley for Belt
209C1	2	Neoprene Band for Pulley
300C7-3	4	Screw, #4-36 x 1/4 Round Head
300C10-2	2	Screw, #6-32 x 1/4 Round Head
300C10-6	3	Screw, #6-32 x 1/2 Round Head
301C7-2	2	Screw, #4-36 x 3/16 Fillister Head
301C10-3	1	Screw, #6-32 x 3/8 Fillister Head
309C12-2	1	Stop Screw, L.H. Shoe
712C1	1	R.H. Slide with Pulley
712C1-1	1	L.H. Slide with Pulley
715C1-19	1	Lower Gear Bracket with Cover Brgs., Screws & Wear Plate 5"-13" Knife
715C1-23	1	Lower Gear Bracket (Complete)
728C1-5	2	Stabilizer Assembly
743C1-26	1	R.H. Shoe (Wave Knife Only)
743C1-27	1	L.H. Shoe (Wave Knife Only)
743C1-28	1	R.H. Pre-set Sharpener Shoe (Only)
743C1-29	1	L.H. Pre-set Sharpener Shoe (Only)
820C1-7	1	L.H. Complete Shoe Assembly
820C1-8	1	R.H. Complete Shoe Assembly

Note: Please specify model and serial number of machine when ordering parts.

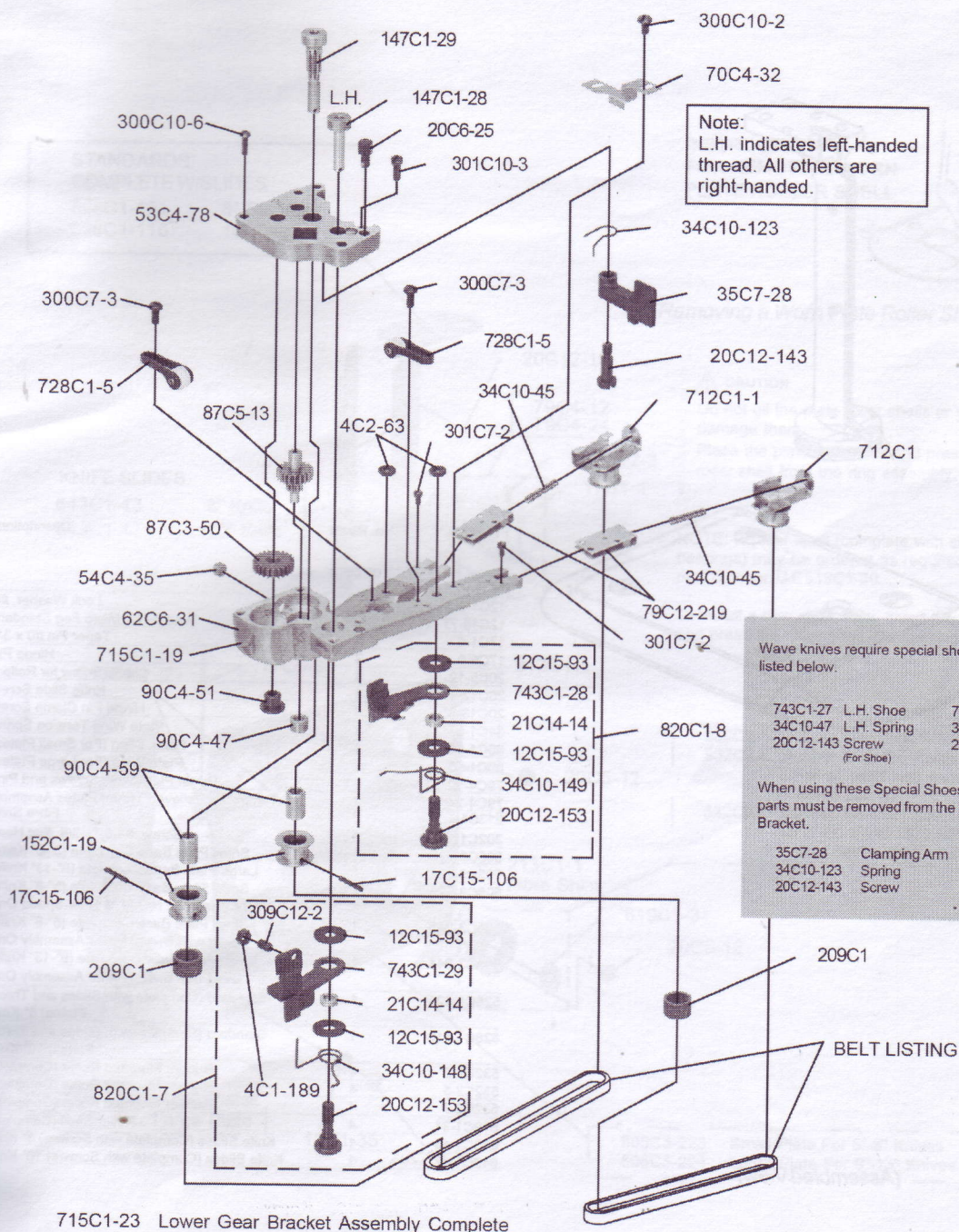

■ Standard and Baseplate Assembly

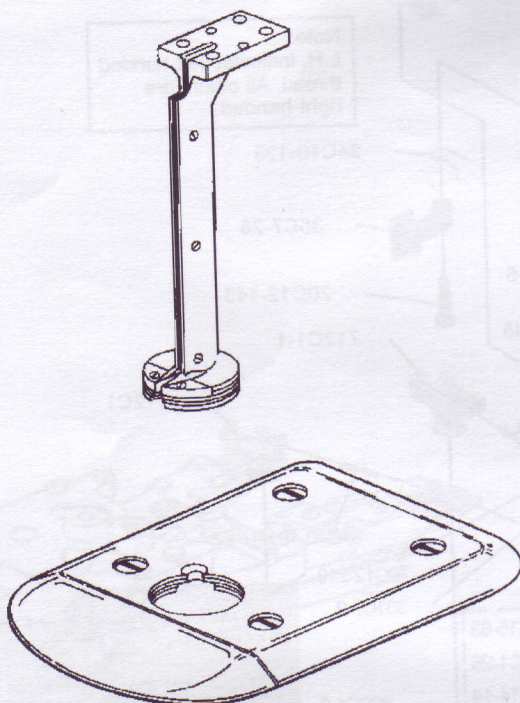

(Assembled View)

Part No.	No. Req'd	Description
For both		
12C1-35	4	Lock Washer, #8
12C15-77	1	Washer for Micro Fog Standard
17C1-4	2	Taper Pin #0 x 3/4
17C6-9	2	Hinge Pin
20C5-12	8	Clamp Screw for Rollers
20C12-19	1	Knife Slide Screw
20C13-51	4	Hinge Pin Clamp Screw
34C1-57	2	Plate Wing Tension Spring
60C1-55	1	Plate Wing (For Small Plates)
60C1-56	1	Plate Wing (For Large Plates)
79C4-12	1	Throat Plates with Screws and Pins
79C4-24	1	Tapered & Relieved Throat Plates Assembly
213C1-1	6	Fibre Shim
302C12-3	3	Screw, #8-32 x 3/8 Flat Head
505C3-223	1	Small Plate Base Complete (5"-8" Knife)
505C3-224	1	Large Plate Base Complete (9"-13" Knife)
505C3-226	1	Small Plate Base Complete (5"-8" Knife)
		For 50 Cycle 1500 R.P.M. & Dual-Speed Only
505C3-243	1	Small Plate Base Complete (5"-8" Knife)
		Used with Swivel Roller Assembly Only
505C3-244	1	Large Plate Base Complete (9"-13" Knife)
		Used with Swivel Roller Assembly Only
528C1-121	1	Standard (Complete with Slides and Throat Plates) 8" Knife
528C1-116	1	Standard (Complete with Slides and Throat Plates) 10" Knife
532C2-3	4	Rubber Mounted Roller (Complete)
532C2-5	4	Rubber Mounted Roller (Complete)
532C2-7	4	Rubber Mounted Roller (Complete)
		Roller Shell (Complete)
619C1-31	4	Knife Slides (Complete with Screws) 8" Knife
643C1-43	1	Knife Slides (Complete with Screws) 10" Knife
643C1-47	1	Knife Slides (Complete with Screws) 10" Knife

Note: Please specify model and serial number of machine when ordering parts.

STANDARDS
COMPLETE W/SLIDES
528C1-121 8" Standard
528C1-116 10" Standard

KNIFE SLIDES

643C1-43 8" Knife
643C1-47 10" Knife

INSTRUCTIONS FOR REMOVING WORN PLATE ROLLER SHELL

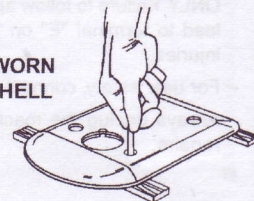

Removing a Worn Plate Roller Shell

CAUTION

Do not oil the plate roller shells or you may damage them.

Place the plate on blocks and press out the roller shell from the ring assembly.

NOTE: A roller shell (complete with shaft and bearings) may be ordered as required. Specify part number GE619C1-30.

To install a new roller shell, invert the baseplate and press the roller shell into the ring assembly.

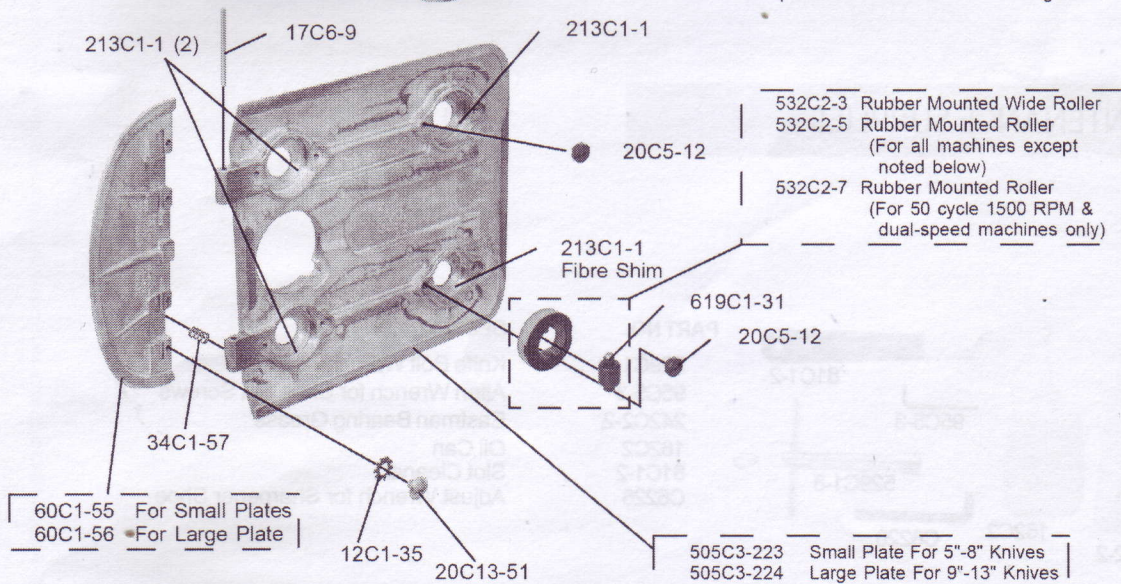

■ Electrical Connections

⚠ WARNING

Electrical connections to this machine must be made by a qualified electrician ONLY. Failure to follow applicable codes and regulations and conduct a ground lead to terminal "E" on the attachment plug may result in serious personal injuries.

For user safety, connect a ground lead to terminal "E" on the attachment plug.

Always unplug the machine before performing maintenance, adjustment or repairs.

	10A 380V 3~	10A 220V 3~	10A 220V ~	15A 120V ~
Description				
Attachment Plug	523C1-99	523C1-100	523C1-101	523C1-102
Terminal Block	508C1-99	508C1-100	508C1-101	508C1-102

■ MAINTENANCE SUPPLIES

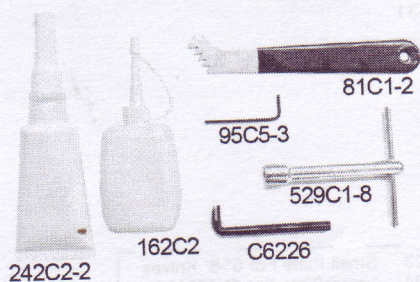

PART NO.

529C1-8
95C5-3
242C2-2
162C2
81C1-2
C6226

DESCRIPTION

Knife Bolt Wrench
Allen Wrench for Shoe Set Screws
Eastman Bearing Grease
Oil Can
Slot Cleaner
Adjust Wrench for Sharpener Shoe

Maintenance records

WT.M03.09XV6W.WWW

WAYKEN

CLOTH CUTTING MACHINE

Use Manual and Parts List

INSTRUCTIONS



www.wayken.com.tw

偉群製刀工業股份有限公司(台灣)

GREAT KNIVES MANUFACTURE CO., LTD

Head Office (Taiwan)

248新北市五股區五工三路115號

NO, 115 Wugong 3rd Road, Wugu District,

New Taipei City 248, Taiwan(R.O.C.)

TEL: +886 2 2299-1297

FAX: +886 2 2299-1298

www.greatknives.com.tw

