

SEIKO

PARTS LIST FOR MODELS

CW-1, 7, 7B, 8, 8B, 8V, 8BV
LCW-7, 7B, 8, 8B, 8V, 8BV, 6F
CYLINDRICAL BED MACHINES



SEIKO SEWING MACHINE CO., LTD.
TOKYO · JAPAN

INDEX

	Page
Thread take up lever, needle bar for all models	1
天秤・針棒関係	
Arm shaft, feeding mechanism for CW.LCW-7, 8 & 8V	2
CW・LCW-7, 8 & 8V 上軸・送り機構関係	
Lifting lever, face plate, slide plate for all models	3
弓、面板、差し板、ベース関係	
Presser bar, lifting rock shaft, vibrating presser foot for CW.LCW-8, 8B, 8V & 8BV . . .	4
CW・LCW-8, 8B, 8V, & 8BV 押え棒・横軸・中押え関係	
Hook driving shaft, rotating hook, timing belt for all models	5
下軸、カマ関係	
Thread tension, feed driving rock shaft, feeder, needle plate for all models	6
糸掛、糸調子、送り竿関係	
Accessories	7
附属関係	
Reverse stitch mechanism for CW.LCW-7B, 8B & 8BV	8
CW・LCW-7B・8B&8BV バック関係	
Special parts for CW.LCW-8V & 8BV	9
CW・LCW-8V&8BV 専用部品	
Presser bar, needle bar, needle plate, feeder for CW.LCW-7 & 7B	10
CW・LCW-7 & 7B 針棒・押え棒関係	
Special parts for LCW	11
LCW 専用部品	
Special parts for CW-1	12
CW-1 専用部品	
Belt guard	13
ベルトガード	
Special parts for LCW-6F	14
LCW-6F 専用部品	
Feed mechanism for LCW-8B	15
LCW-8B 送り関係	

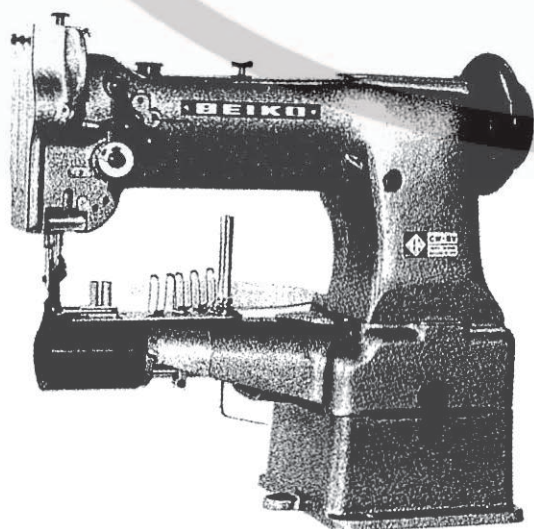

Model CW-8V

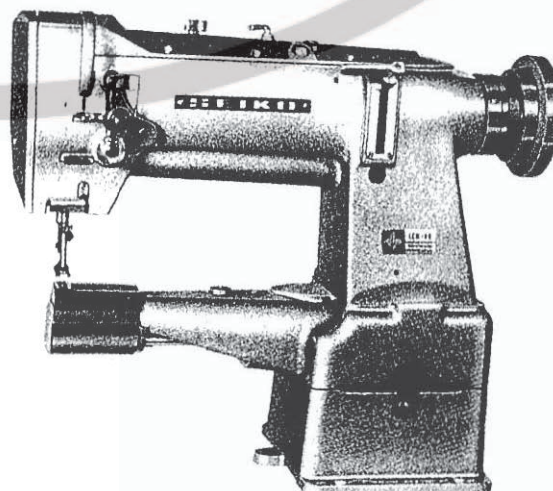

Model LCW-8B

天秤・針棒関係

THREAD TAKE UP LEVER, NEEDLE BAR, ETC. FOR ALL MODELS EXCEPT PARTS MARKED * . O . X . Δ

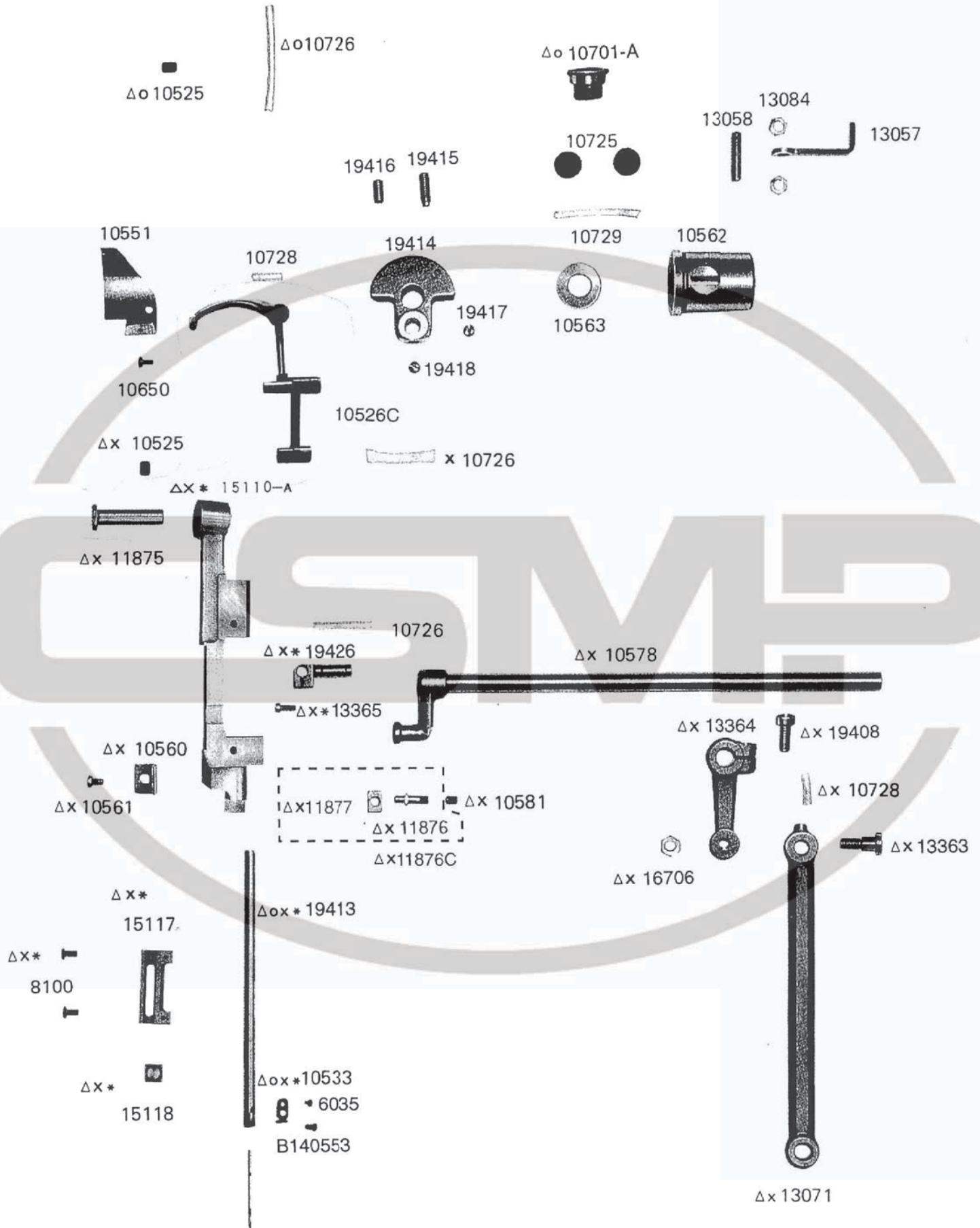

Parts marked * are not necessary for CW-7 & 7B
 Parts marked O are not necessary for LCW
 Parts marked X are not necessary for CW-1
 Parts marked Δ are not necessary for LCW-6F

(*印は CW-7, CW-7B には不要)
 (O印は LCW タイプには不要)
 (X印は CW-1 には不要)
 (Δ印は LCW-6F には不要)

ARM SHAFT, FEEDING MECHANISM
FOR CW・LCW - 7, 8 & 8V

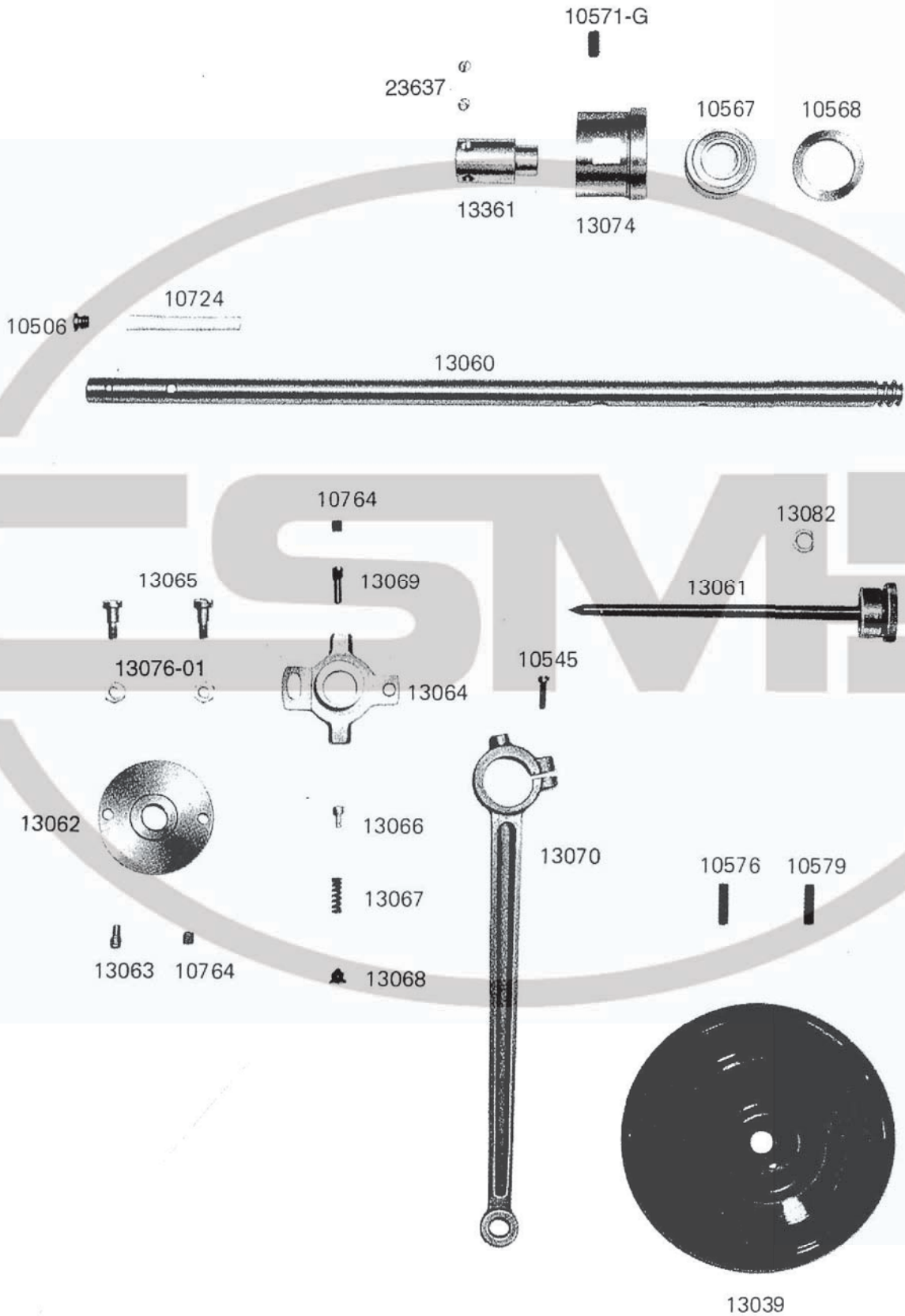

3

弓, 面板, 差し板, ベース関係

LIFTING LEVER, FACE PLATE, SLIDE PLATE FOR ALL MODELS EXCEPT PARTS MARKED ○.x.*

10712

13056-A



13059



○ 10707

10706



10705



13079A

○ 10699



○ 10704

○ 10703

x○ 10702

13440
37100



x○ 10698

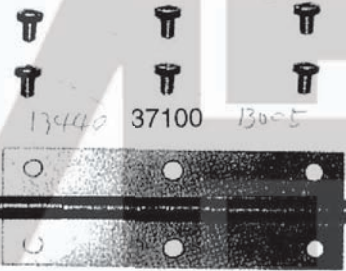

13004
13436

○ 10700

13027



13026



13024



13025



13027



x13009

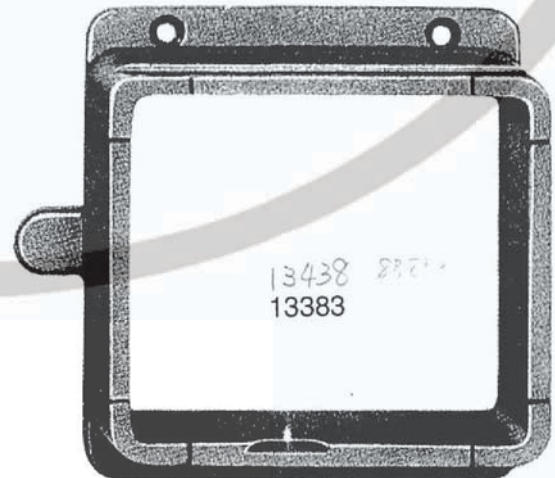

13438
13383

13089



19403



13006



13388-A

13008

Parts marked * are not necessary for CW.LCW-8V & 8BV (*印は CW・LCW-8V & 8BV には不要)
 Parts marked ○ are not necessary for LCW (○印は LCW には不要)
 Parts marked X are not necessary for CW-1 (X印は CW-1 には不要)

CW・LCW-8, 8B, 8V, & 8BV 押え棒・横軸・中押え関係
 PRESSER BAR, LIFTING ROCK SHAFT, VIBRATING PRESSER
 FOR CW・LCW - 8, 8B, 8V & 8BV

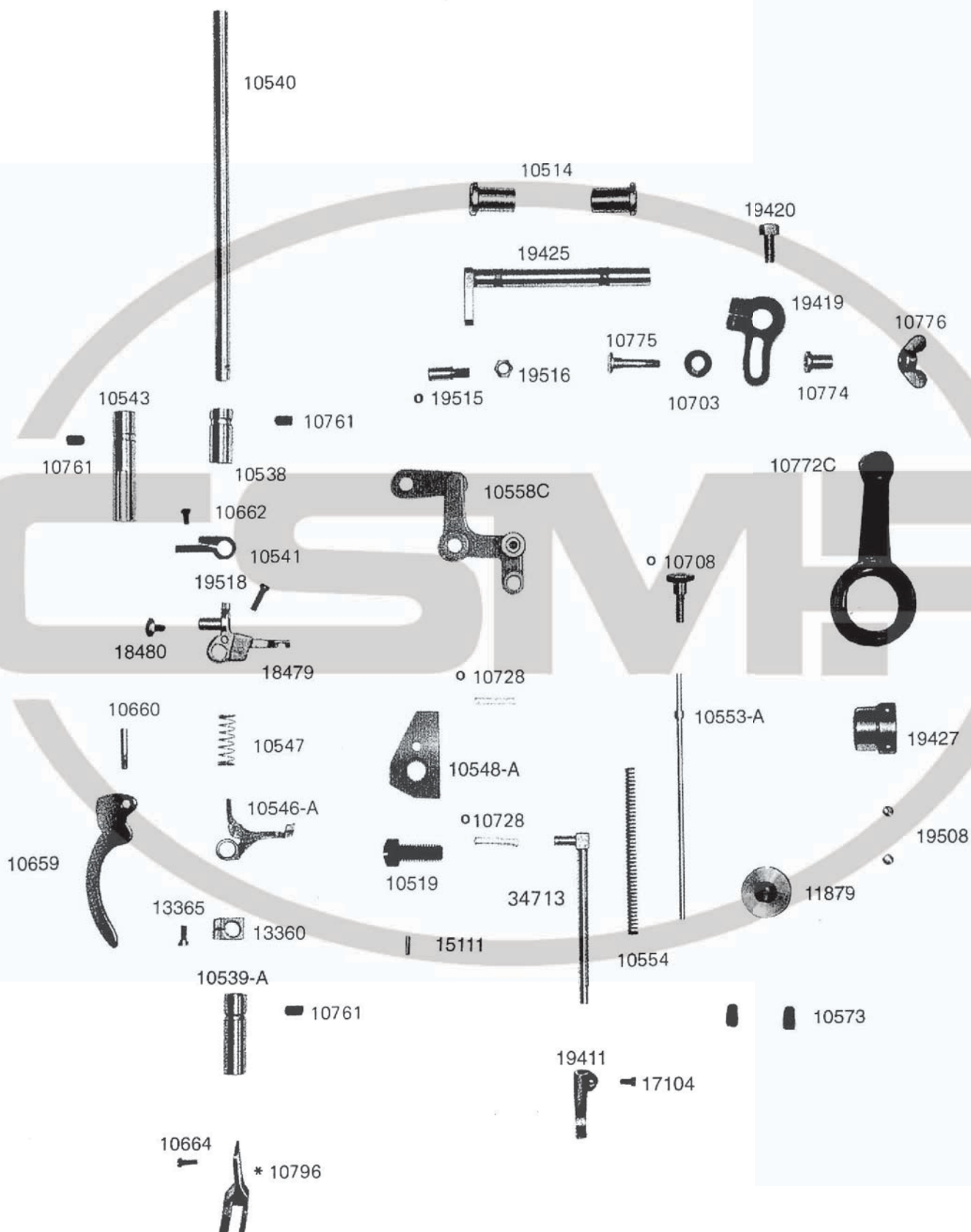

Parts marked * are not necessary for CW・LCW-8V & 8BV
 Parts marked ○ are not necessary for LCW

(*印は CW-8V, CW-8BV, LCW-8V, LCW-8BV には不要)
 (○印は LCW には不要)

HOOK DRIVING SHAFT, ROTATING HOOK, TIMING BELT FOR ALL MODELS EXCEPT PARTS MARKED * . + . - . X . Δ

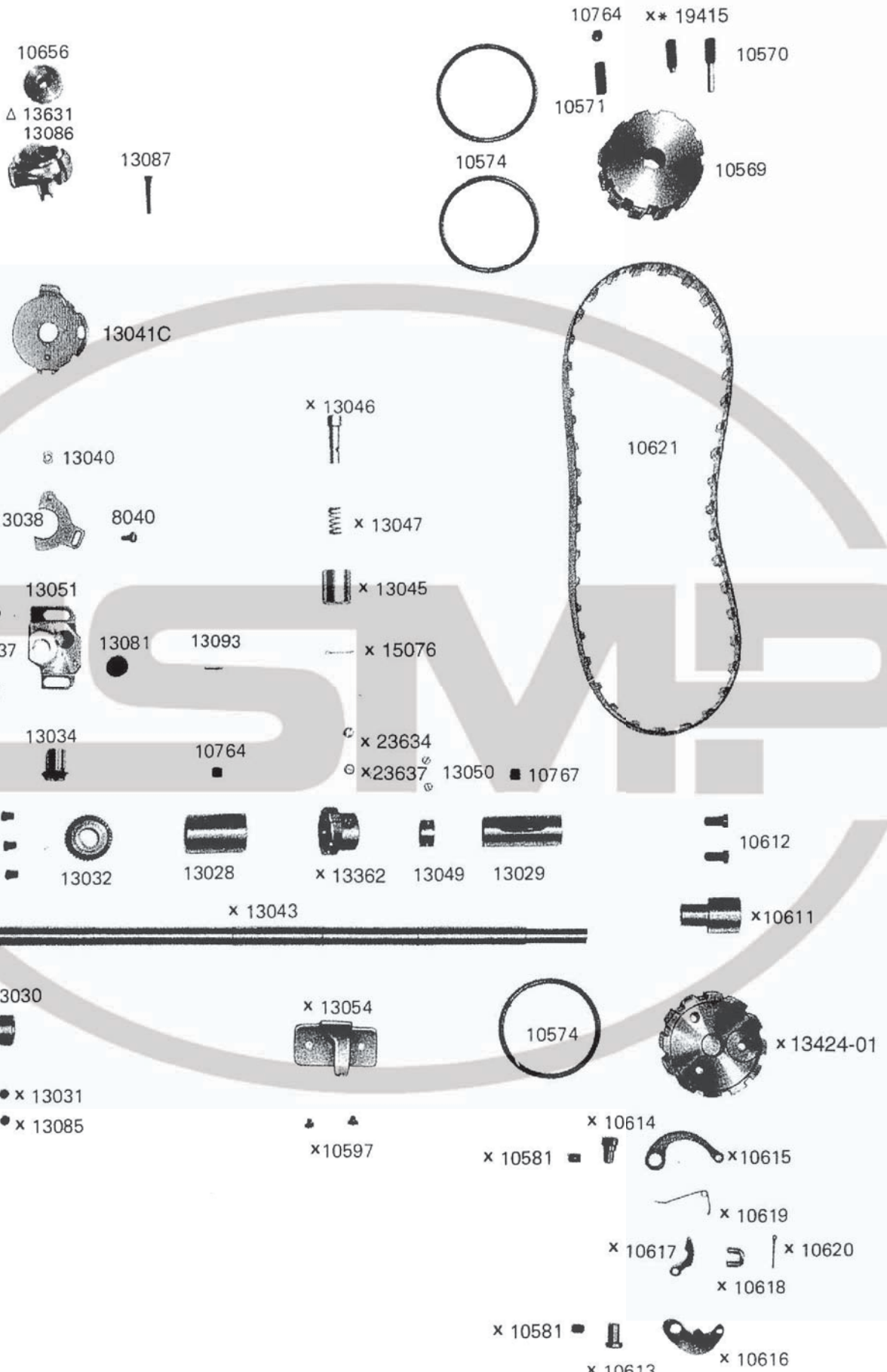

Part marked * is not necessary for CW . LCW-7B . 8B & 8BV
 Part marked + is for only CW . LCW-7B . 8B & 8BV
 Part marked - is not necessary for CW . LCW-8V & 8BV
 Parts marked X are not necessary for CW-1
 Parts marked Δ is for only LCW-6F

(*印は CW・LCW-7B、8B&8BV には不要)
 (+印は CW・LCW-7B、8B&8BV にのみ)
 (-印は CW・LCW-8V&8BV には不要)
 (X印は CW-1 には不要)
 (Δ印は LCW-6F のみ)

THREAD TENSION, FEED DRIVING ROCK SHAFT, FEEDER, NEEDLE
PLATE FOR ALL MODELS EXCEPT PARTS MARKED * . + . ○ . X . △

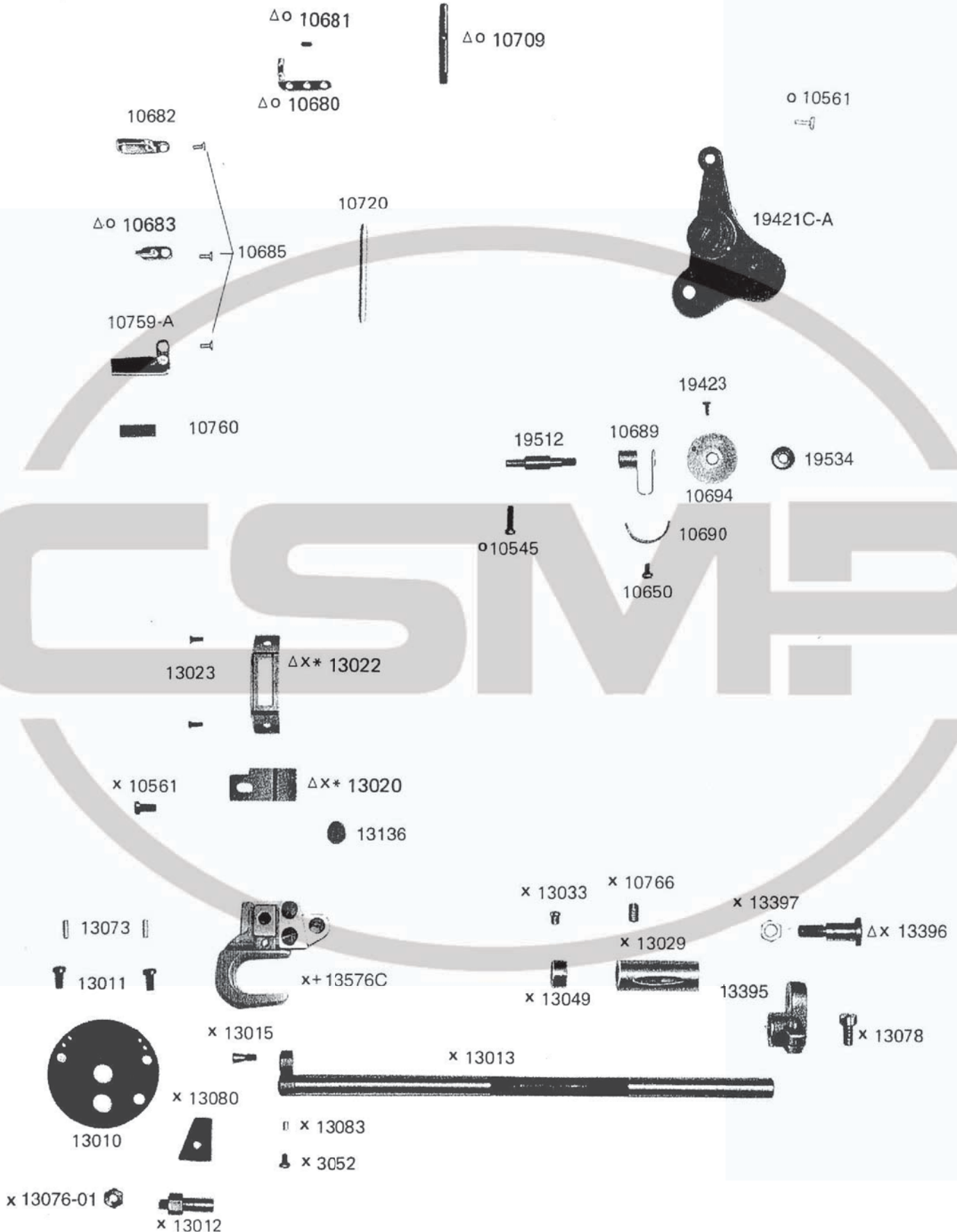

Parts marked * are not necessary for CW . LCW-7 . 7B . 8V & 8BV (*印は CW-LCW-7, 7B, 8V&8BV には不要)

Parts marked + are not necessary for CW . LCW-8V & 8BV (+印は CW-LCW-8V&8BV には不要)

Parts marked ○ are not necessary for LCW (○印は LCW には不要)

Parts marked X are not necessary for CW-1 (X印は CW-1 には不要)

Parts marked △ are not necessary for LCW-6F (△印は LCW-6F には不要)

(+印は CW-LCW-8V&8BV には不要)

(○印は LCW には不要)

(X印は CW-1 には不要)

(△印は LCW-6F には不要)



8132A



10656

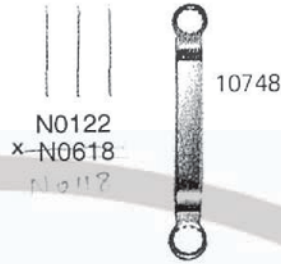

N0122
X-N0618
No.117

10748

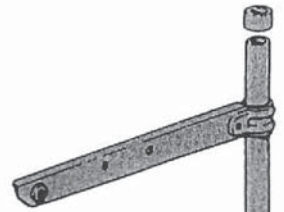

35254

10734

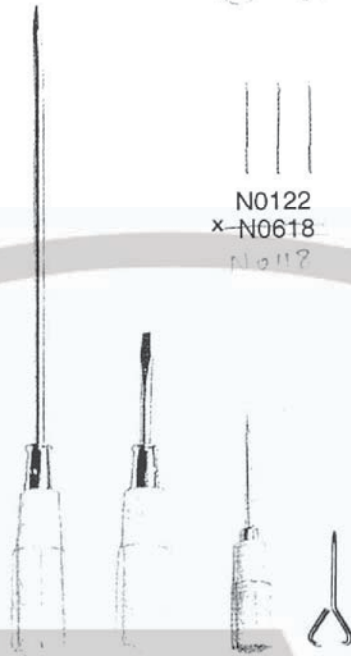

8118C

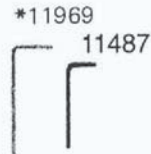

*11969

11487



8123
O 11193

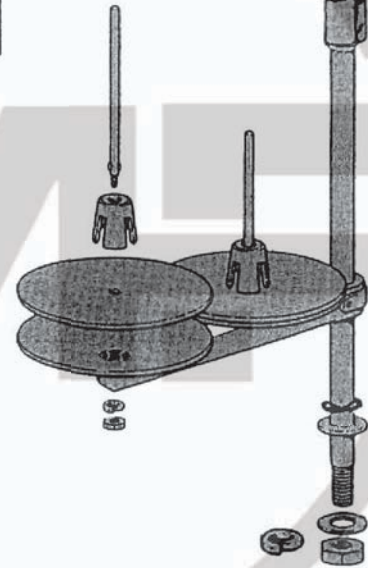

10709



13094



8124



13096

Part marked X is used for only CW-1

Part marked O is used for only LCW

Part marked * is used for only CW, LCW-7B, 8B & 8BV

(X印は CW-1のみ)

(O印は LCWのみ)

(*印は CW, LCW-7B, 8B&8BVのみ)

CW・LCW-7B・8B&8BV バック関係
 REVERSE STITCH MECHANISM FOR
 CW・LCW-7B, 8B & CW-8BV

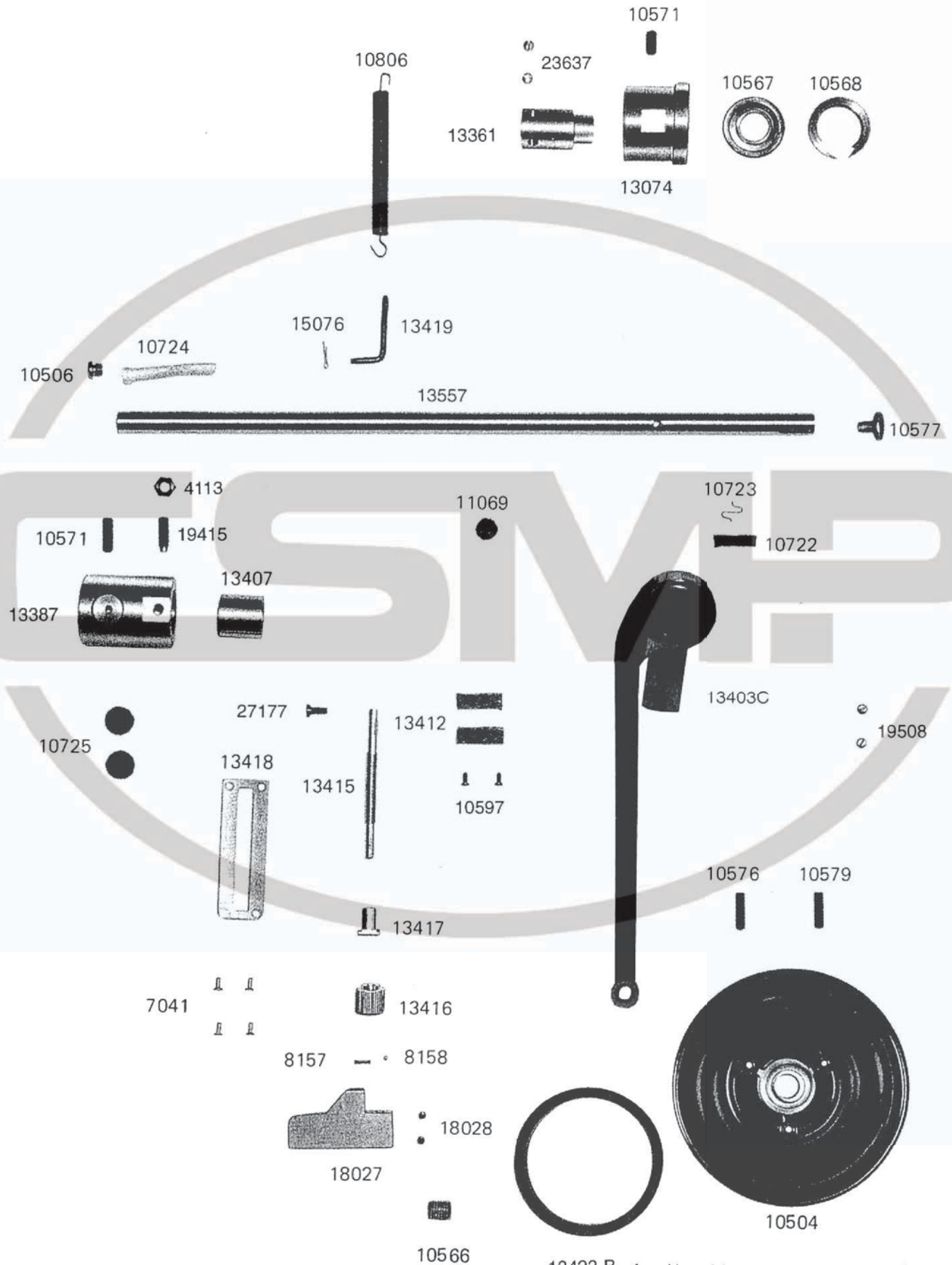

13423-B A ... Use with guard A ... ガード付用
 B ... Use without guard B ... ガード無用

CW · LCW- 8 V & 8 BV 専用部品
SPECIAL PARTS FOR CW · LCW – 8V & 8BV

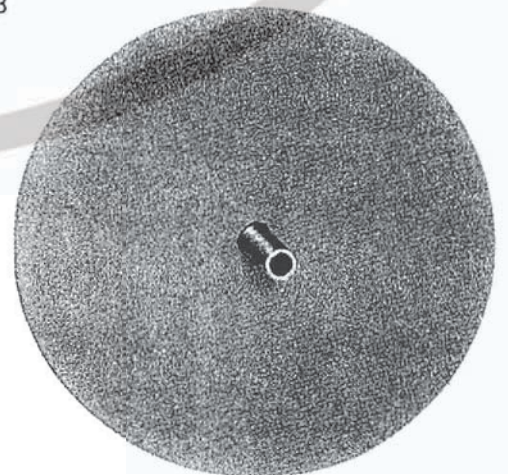
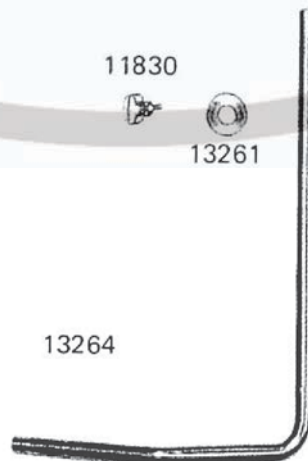
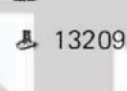
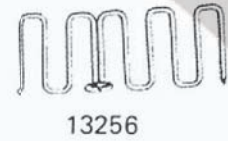
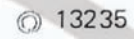
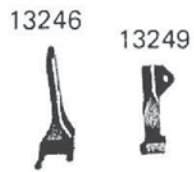

CW · LCW-7 & 7B 針棒 · 押え棒関係
 PRESSER BAR, NEEDLE BAR, NEEDLE PLATE, FEEDER
 FOR CW · LCW - 7 & 7B

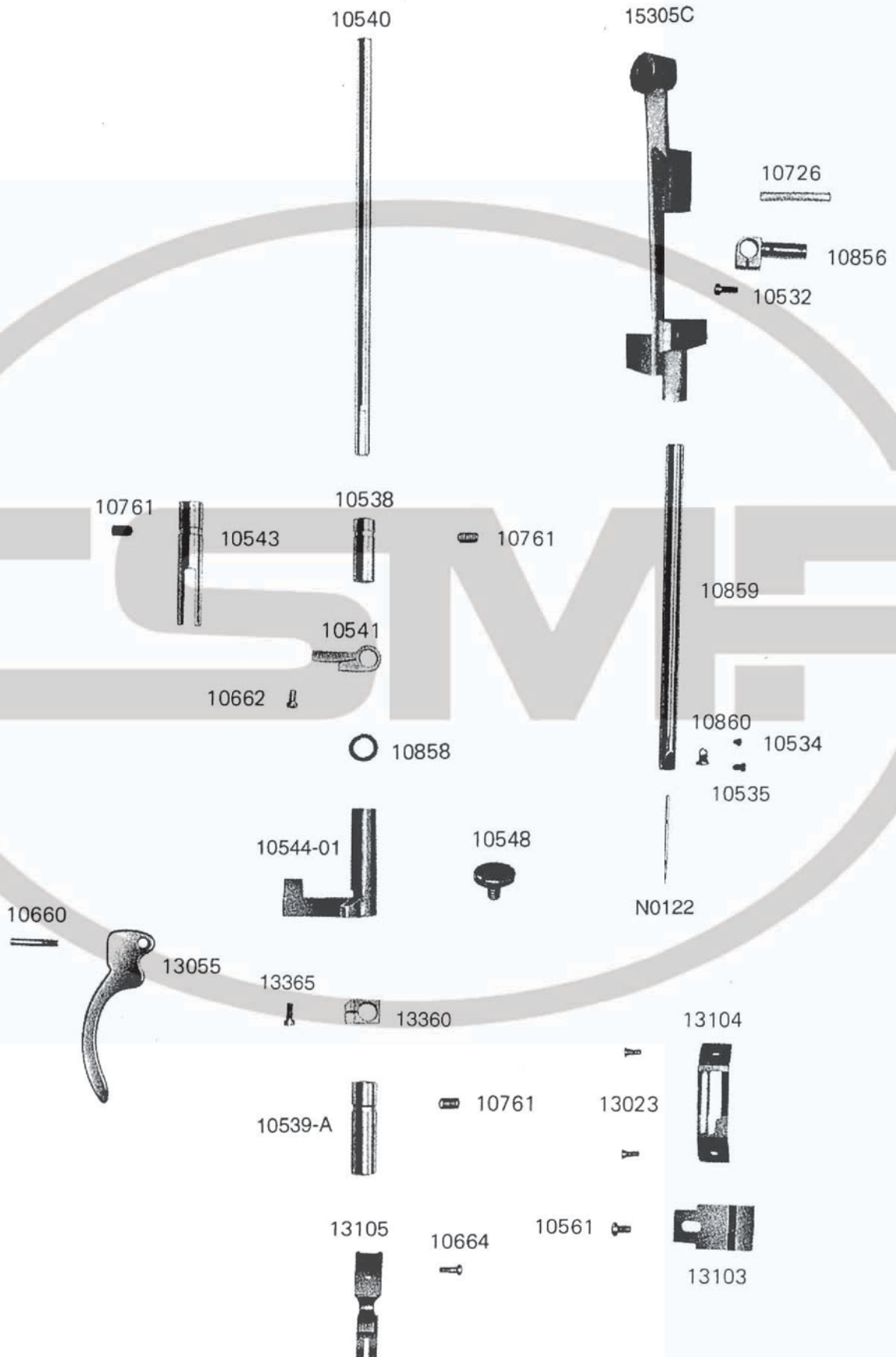

LCW 専用部品 SPECIAL PARTS FOR LCW

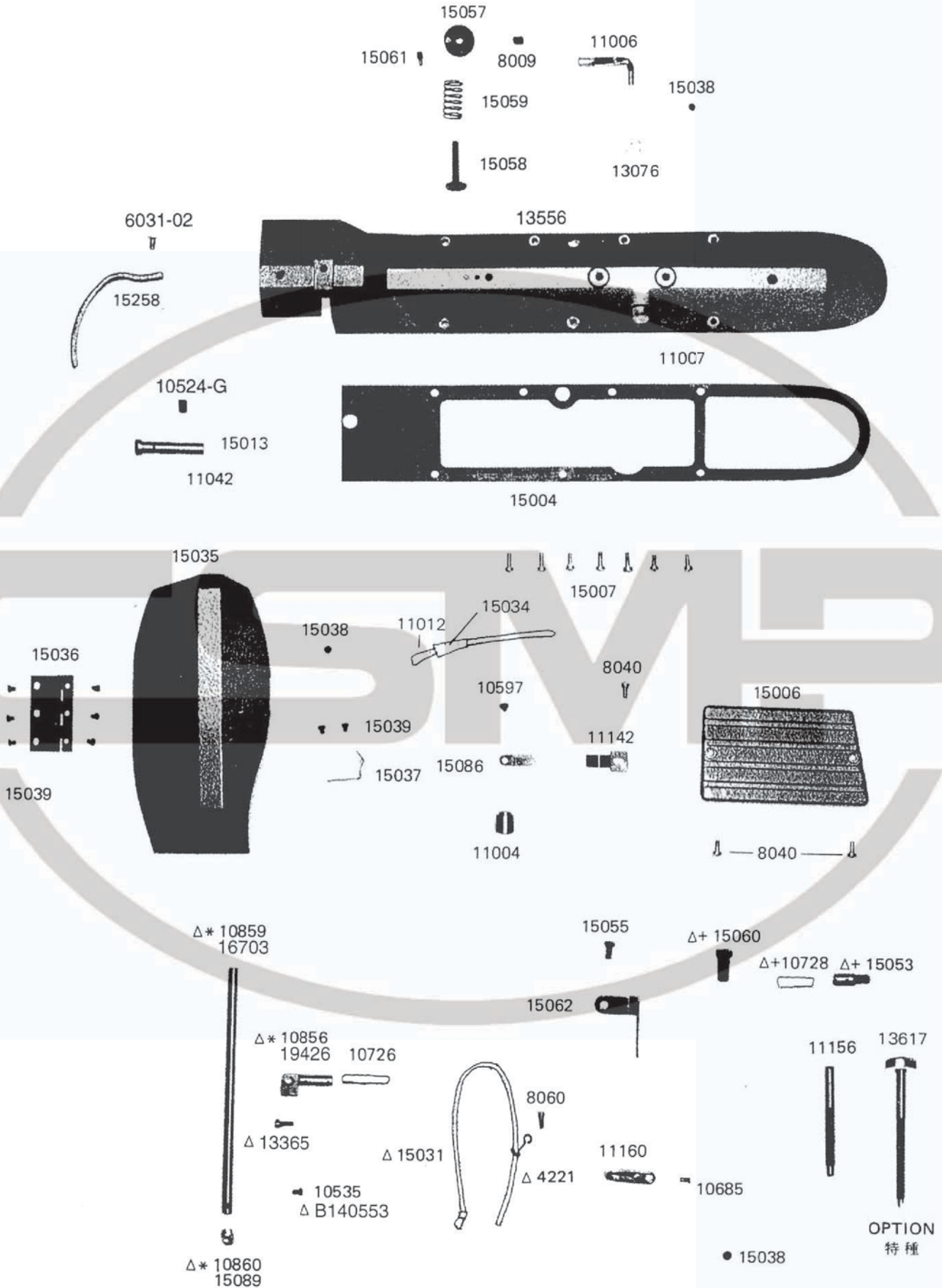

Parts marked * is used for only LCW-7, 7B
 Parts marked + is used for only LCW-8, 8V, 8B & 8BV
 Parts marked Δ is not necessary for LCW-6F

(*印は LCW-7, 7B のみ)
 (+印は LCW-8, 8V, 8B & 8BV のみ)
 (Δ印は LCW-6F には不要)

CW-1 専用部品
SPECIAL PARTS FOR CW-1

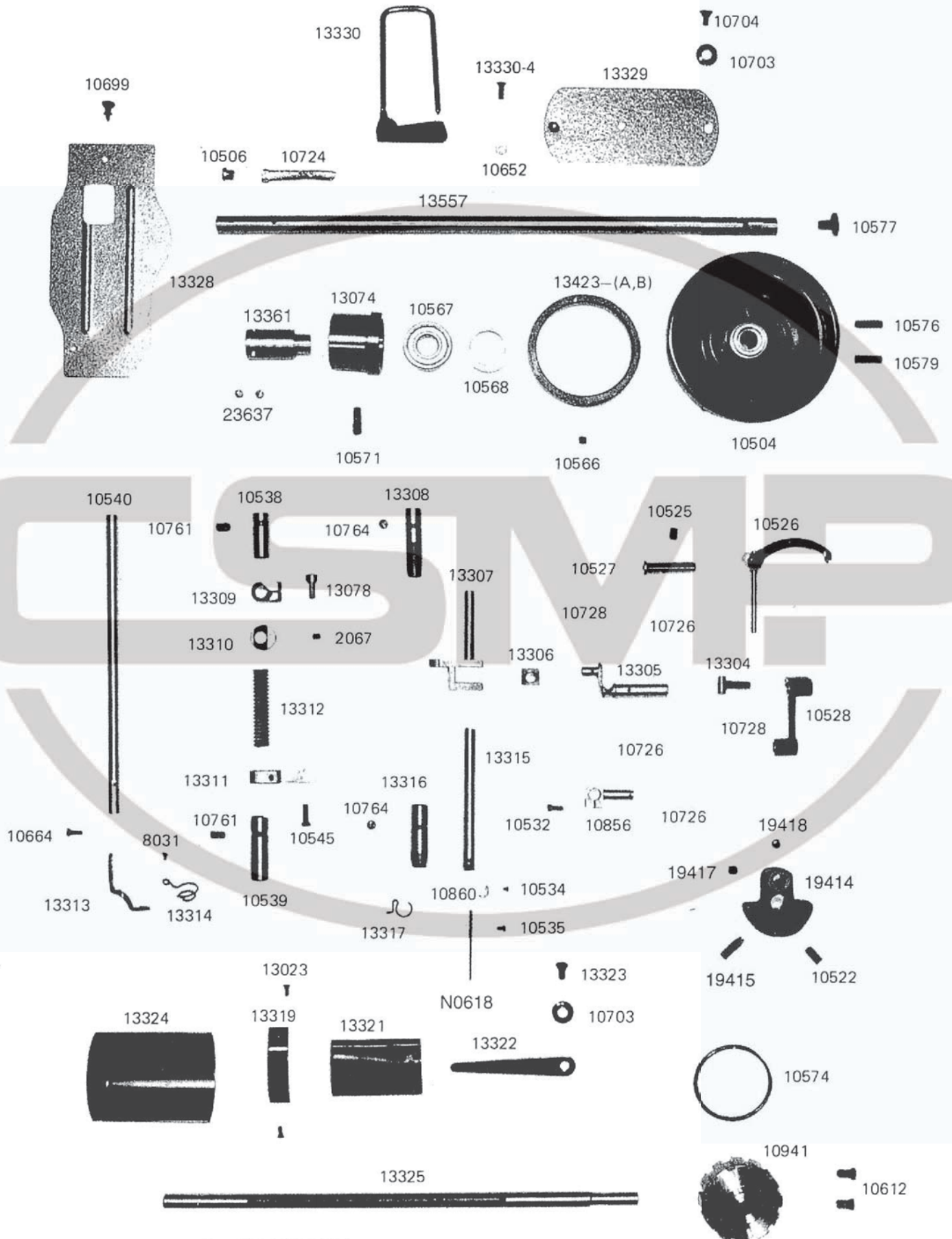

NOTE) 13423 A ... Use with guard B ... Use without guard 注) 13423

A ガード付用
B ガード無用

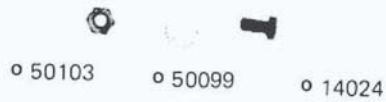
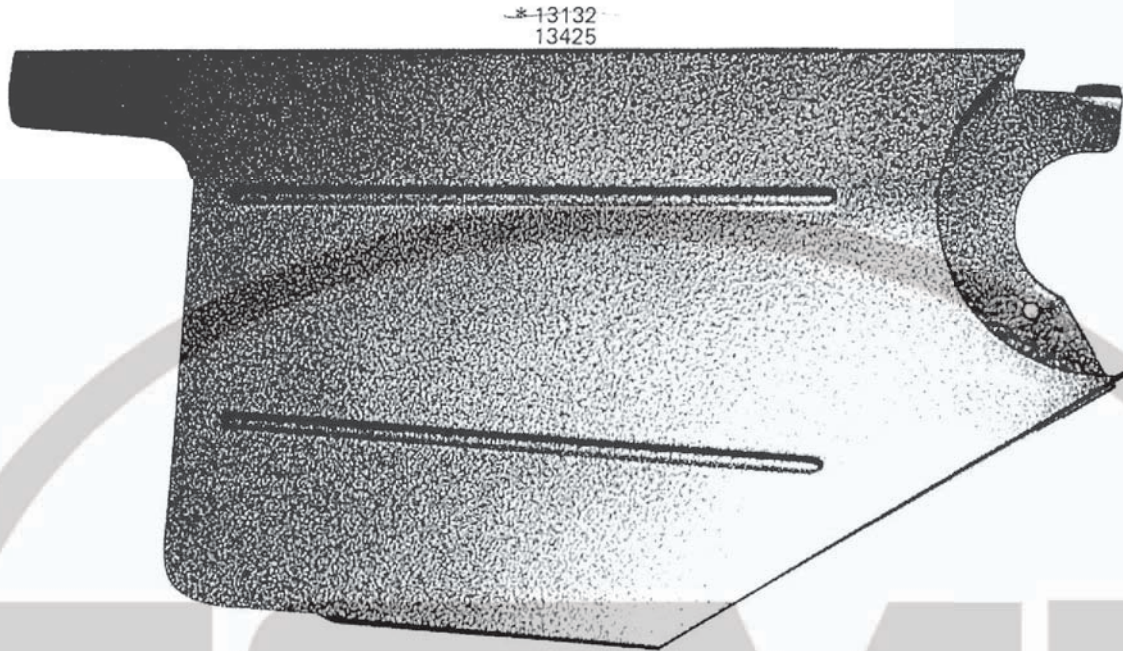

○ 13427

11142 10561

*13133
13426
△12294-2



Parts marked ○ are not used CW, LCW-7, 8 & 8V.
Parts marked * are used for only CW, LCW-7, 8 & 8V.
Parts marked △ are used for only LCW-6F

(○印は CW・LCW-7、8 & 8V には不要)
(*印は CW・LCW-7、8 & 8V のみ)
(△印は LCW-6F のみ)

SPECIAL PARTS FOR LCW - 6F

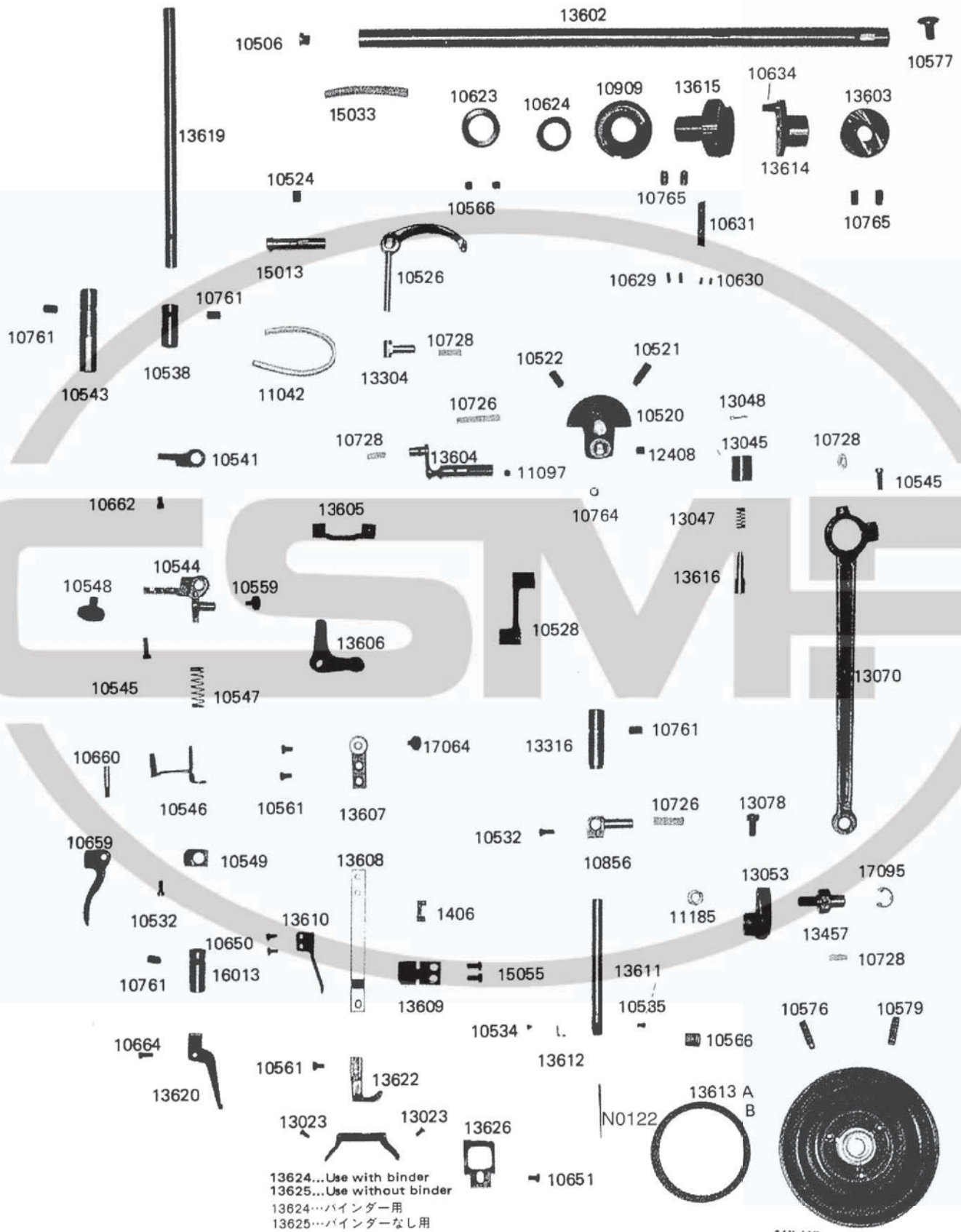

13624...Use with binder
 13625...Use without binder
 13624...バインダー用
 13625...バインダーなし用

注) 13613 A.....Use with guard (Aガード付用)
 B.....Use without guard (Bガード無用)

LCW-8B 送り関係

FEED MECHANISM FOR LCW - 8B

